

Preliminary
Not for Construction

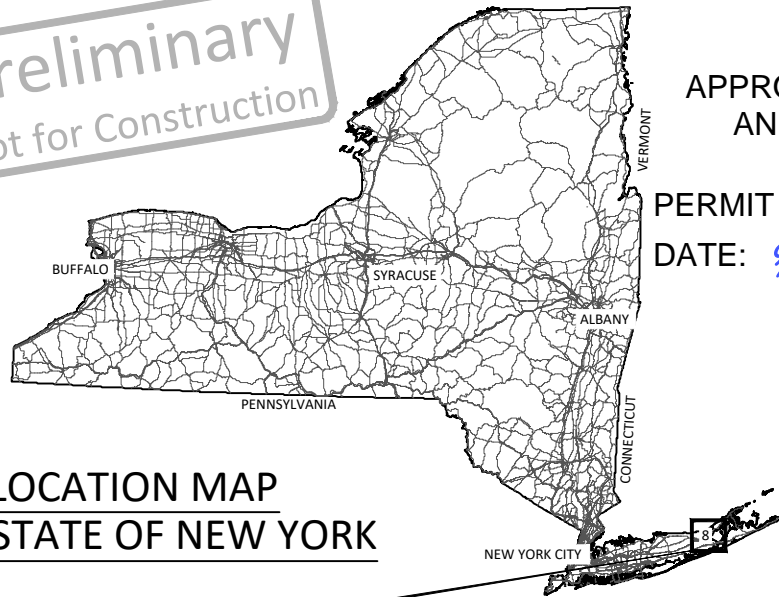

**LOCATION MAP
STATE OF NEW YORK**

**MEETINGHOUSE CREEK
STORMWATER WETLAND AND HABITAT RESTORATION**
NYSDEC **NEIWPC**, PECONIC ESTUARY PARTNERSHIP,
APPROVED AS PER TERMS AND CONDITIONS OF **& THE TOWN OF RIVERHEAD**

PERMIT NO **1-4730-01079/00002**

AQUEBOGUE, NY

DATE: **9/7/2023**

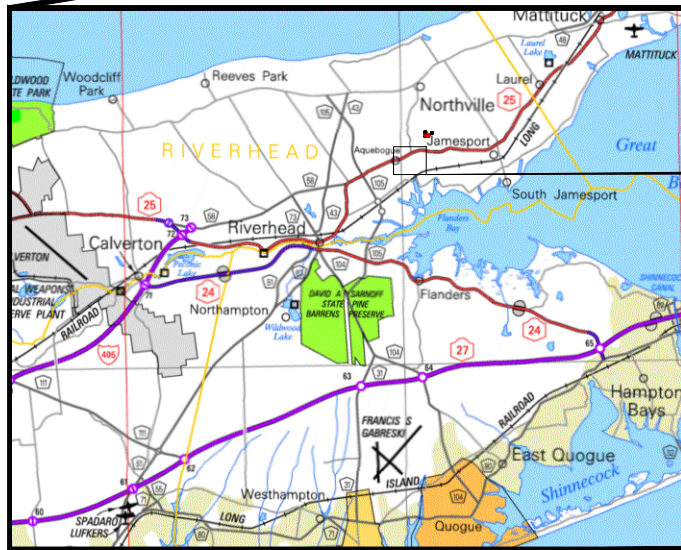

VICINITY MAP

SHEET INDEX

- 1 - COVER, LOCATION, & SHEET INDEX
- 2 - GENERAL NOTES
- 3 - EXISTING CONDITIONS
- 4 - SITE ACCESS, REMOVALS, AND EROSION AND SEDIMENT CONTROL
- 5 - GRADING PLAN
- 6 - SURFACE TREATMENT PLAN
- 7 - GRADING PROFILES
- 8 - GRADING SECTIONS (1 OF 2)
- 9 - GRADING SECTIONS (2 OF 2)
- 10 - TYPICAL CONSTRUCTION SECTION (1 OF 2)
- 11 - TYPICAL CONSTRUCTION SECTIONS (2 OF 2)
- 12 - FABRIC ENCAPSULATED SLOPE LIFTS DETAILS (1 OF 2)
- 13 - FABRIC ENCAPSULATED SLOPE LIFTS DETAILS (2 OF 2)
- 14 - DRAINAGE & SITE ACCESS DETAILS
- 15 - MICROTOPOGRAPHY
- 16 - NATIVE PLANTING PLAN
- 17 - NATIVE PLANTING NOTES

SITE MAP

THIS PROJECT HAS BEEN FUNDED WHOLLY OR IN PART BY NYS DOT AND THE UNITED STATES ENVIRONMENTAL PROTECTION AGENCY UNDER ASSISTANCE AGREEMENT (CE97230303) TO NEIWPC IN PARTNERSHIP WITH THE PECONIC ESTUARY PARTNERSHIP.



**NEIWPC, PEP, & TOWN OF RIVERHEAD
MEETINGHOUSE CREEK STORMWATER WETLAND
& HABITAT RESTORATION
AQUEBOGUE, NY**

**COVER, LOCATION, & SHEET
INDEX**

| | |
|-------------------|---------------------|
| MYS DRAWN | CC, SW DESIGNED |
| JK, MH CHECKED | - APPROVED |
| 10/07/22 DATE | 20-05-23 PROJECT |



PURPOSE: STORMWATER BMP & HABITAT RESTORATION
IN: MEETINGHOUSE CREEK COUNTY: SUFFOLK STATE: NY
DATE: 10/07/22
SHEET 1 of 17

GENERAL NOTES

1. THE SPECIFICATIONS FOR THIS PROJECT ARE THE NEW YORK STATE DEPARTMENT OF TRANSPORTATION (NYS DOT) STANDARD SPECIFICATIONS AS SUPPLEMENTED OR AMENDED BY THE CONTRACT DOCUMENTS.
2. THE CONTRACTOR SHALL NOTIFY NEW YORK 811 1-800-272-4480 TWO TO TEN DAYS BEFORE ANY EXCAVATION BEGINS. ALL EXCAVATIONS SHALL BE ACCOMPLISHED IN ACCORDANCE WITH NEW YORK CALL BEFORE YOU DIG REGULATIONS.
3. ALL EXCAVATION MUST FOLLOW OSHA, NEW YORK, AND LOCAL REGULATIONS FOR SAFETY.
4. THE CONTRACTOR SHALL BE RESPONSIBLE FOR SITE SECURITY AND JOB SAFETY, CONSTRUCTION ACTIVITIES SHALL BE IN ACCORDANCE WITH OSHA STANDARDS AND LOCAL REQUIREMENTS.
5. AREAS DISTURBED DURING CONSTRUCTION AND NOT WITHIN THE RESTORATION FOOTPRINT OF THE PLANS SHALL BE RESTORED TO CONFORM WITH THE PREVIOUS UNDISTURBED CONDITION.
6. WORK WITHIN LOCAL RIGHTS-OR-WAY SHALL CONFORM TO LOCAL MUNICIPAL STANDARDS.
7. WORK WITHIN STATE RIGHTS-OR-WAY SHALL CONFORM TO THE LATEST EDITION OF THE STATE HIGHWAY DEPARTMENT'S STANDARD SPECIFICATIONS FOR HIGHWAYS AND BRIDGES.
8. UPON AWARD OF CONTRACT, CONTRACTOR SHALL MAKE NECESSARY CONSTRUCTION NOTIFICATIONS AND APPLY FOR AND OBTAIN NECESSARY PERMITS, PAY FEES, AND POST BONDS ASSOCIATED WITH THE WORK INDICATED ON THE DRAWINGS, IN THE SPECIFICATIONS, AND IN THE CONTRACT DOCUMENTS. DO NOT CLOSE OR OBSTRUCT ROADWAYS, SIDEWALKS, AND FIRE HYDRANTS, WITHOUT APPROPRIATE PERMITS.
9. IN THE EVENT THAT SUSPECTED CONTAMINATED SOIL, GROUNDWATER, OR OTHER MEDIA ARE ENCOUNTERED DURING EXCAVATION AND CONSTRUCTION ACTIVITIES BASED ON VISUAL, OLFACTORY, OR OTHER EVIDENCE, THE CONTRACTOR SHALL STOP WORK IN THE VICINITY OF THE SUSPECT MATERIAL TO AVOID FURTHER SPREADING OF THE MATERIAL, AND SHALL NOTIFY THE OWNER IMMEDIATELY SO THAT THE APPROPRIATE TESTING AND SUBSEQUENT ACTION CAN BE TAKEN.
10. THE CONTRACTOR SHALL PREVENT DUST, SEDIMENT, OR DEBRIS FROM EXITING THE SITE AND SHALL BE RESPONSIBLE FOR CLEANUP, REPAIRS AND CORRECTIVE ACTIONS IF SUCH OCCURS.
11. DAMAGE RESULTING FROM CONSTRUCTION LOADS SHALL BE REPAIRED BY THE CONTRACTOR AT NO ADDITIONAL COST TO THE OWNER.
12. THE CONTRACTOR SHALL CONTROL STORMWATER RUNOFF DURING CONSTRUCTION TO PREVENT ADVERSE IMPACTS TO OFF SITE AREAS AND SHALL BE RESPONSIBLE TO REPAIR RESULTING DAMAGES, IF ANY, AT NO COST TO THE OWNER.
13. THIS PROJECT DISTURBS MORE THAN ONE ACRE OF LAND AND FALLS WITHIN THE SPDES GENERAL PERMIT FOR STORMWATER DISCHARGES FROM CONSTRUCTION ACTIVITY (GP-0-20-001). PRIOR TO THE START OF CONSTRUCTION, A NOTICE OF INTENT SHALL BE FILED WITH NYSDEC AND A STORMWATER POLLUTION PREVENTION PLAN SHALL BE PREPARED IN ACCORDANCE WITH SPDES REQUIREMENTS.

UTILITIES

1. THE LOCATIONS, SIZES, AND TYPES OF EXISTING UTILITIES ARE SHOWN AS AN APPROXIMATE REPRESENTATION ONLY. THE OWNER OR ITS REPRESENTATIVE(S) HAVE NOT INDEPENDENTLY VERIFIED THIS INFORMATION AS SHOWN ON THE PLANS. THE UTILITY INFORMATION SHOWN DOES NOT GUARANTEE THE ACTUAL EXISTENCE, SERVICEABILITY, OR OTHER DATA CONCERNING UTILITIES, NOR DOES IT GUARANTEE AGAINST THE POSSIBILITY THAT ADDITIONAL UTILITIES MAY BE PRESENT THAT ARE NOT SHOWN ON THE PLANS. PRIOR TO BEGINNING CONSTRUCTION, THE CONTRACTOR SHALL VERIFY AND DETERMINE THE EXACT LOCATION, SIZES, AND ELEVATIONS OF THE EXISTING UTILITIES AND, SHALL CONFIRM THAT THERE ARE NO INTERFERENCES WITH EXISTING UTILITIES, INCLUDING ROUTE WITHIN PUBLIC RIGHT-OF-WAY.
2. WHERE AN EXISTING UTILITY IS FOUND TO CONFLICT WITH THE PROPOSED WORK, OR EXISTING CONDITIONS DIFFER FROM THOSE SHOWN, SUCH THAT THE WORK CANNOT BE COMPLETED AS INTENDED, THE LOCATION, ELEVATION, AND SIZE OF THE UTILITY SHALL BE ACCURATELY DETERMINED WITHOUT DELAY BY THE CONTRACTOR, AND THE INFORMATION FURNISHED IN WRITING TO THE ENGINEER FOR THE RESOLUTION OF THE CONFLICT. CONTRACTOR'S FAILURE TO NOTIFY PRIOR TO PERFORMING ADDITIONAL WORK RELEASES OWNER FROM OBLIGATIONS FOR ADDITIONAL PAYMENTS WHICH OTHERWISE MAY BE WARRANTED TO RESOLVE TO CONFLICT.
3. THE CONTRACTOR SHALL PROTECT EXISTING UTILITIES THAT MAY BE LOCATED WITHIN THE ACCESS ROUTES OR IN THE WORK AREA FROM DAMAGES. EXISTING UTILITIES LIKELY TO BE IN THE WORK AREA INCLUDE, BUT ARE NOT LIMITED TO MANHOLE STRUCTURES, RIMS, AND COVERS; OVERHEAD UTILITY POLES; STORMWATER DRAINAGE PIPES; STORMWATER OUTFALL STRUCTURES INCLUDING, BUT NOT LIMITED TO APRONS AND HEADWALLS.
4. ANY UTILITY INFRASTRUCTURE THAT IS DAMAGED DURING THE PERFORMANCE OF THE WORK SHALL BE REPLACED IN KIND AT NO COST TO THE OWNER.
5. SET INVERTS OF STORMWATER FEATURES IN ACCORDANCE WITH ELEVATIONS ON THE PLANS.
6. THE CONTRACTOR SHALL MAKE ARRANGEMENTS FOR AND SHALL BE RESPONSIBLE FOR POLE RELOCATION AND FOR THE ALTERATION AND ADJUSTMENT OF GAS, ELECTRIC, TELEPHONE, FIRE ALARM, AND OTHER PRIVATE UTILITIES, WHETHER WORK IS PERFORMED BY CONTRACTOR OR BY THE UTILITIES COMPANY.

LAYOUT AND MATERIALS

1. ANY EXISTING PROPERTY LINE MONUMENTATION DISTURBED DURING CONSTRUCTION SHALL BE SET OR RESET BY A PROFESSIONAL LICENSED SURVEYOR.
2. PRIOR TO THE START OF CONSTRUCTION, THE CONTRACTOR SHALL VERIFY EXISTING ELEVATIONS AT THE INTERFACE WITH STORMWATER OUTFALL STRUCTURES, DOWNSTREAM GRADE, AND OTHER TIE-IN LOCATIONS TO ASSURE PROPER TRANSITIONS BETWEEN EXISTING AND PROPOSED FEATURES.
3. SYMBOLS AND LEGENDS OF PROJECT FEATURES ARE GRAPHIC REPRESENTATIONS AND ARE NOT NECESSARILY SCALED TO THEIR ACTUAL DIMENSIONS OR LOCATIONS ON THE DRAWINGS. THE CONTRACTOR SHALL REFER TO THE DETAIL SHEET DIMENSIONS, SHOP DRAWINGS, AND FIELD MEASUREMENTS OF SUPPLIED PRODUCTS FOR LAYOUT OF THE PROJECT FEATURES.

EARTHWORK

1. EARTHWORK SHALL BE CARRIED OUT WITH ON-SITE OBSERVATION BY THE ENGINEER.
2. THE CONTRACTOR SHALL DISPOSE OF EXCAVATED DELETERIOUS MATERIAL IN ACCORDANCE WITH APPLICABLE FEDERAL, STATE, AND LOCAL REGULATIONS, ORDINANCES, AND STATUTES.
3. UNLESS OTHERWISE SPECIFICALLY PROVIDED ON THE PLANS OR IN THE SPECIFICATIONS, THE ENGINEER HAS NOT PREPARED DESIGNS FOR AND SHALL HAVE NO RESPONSIBILITY FOR THE PRESENCE, DISCOVERY, REMOVAL, ABATEMENT OR DISPOSAL OF HAZARDOUS MATERIALS, TOXIC WASTES OR POLLUTANTS AT THE PROJECT SITE. THE ENGINEER SHALL NOT BE RESPONSIBLE FOR ANY CLAIMS OF LOSS, DAMAGE, EXPENSE, DELAY, INJURY OR DEATH ARISING FROM THE PRESENCE OF HAZARDOUS MATERIAL AND THE CONTRACTOR SHALL INDEMNIFY AND HOLD HARMLESS THE ENGINEER FROM ANY CLAIMS MADE IN CONNECTION THEREWITH.

EROSION AND SEDIMENTATION CONTROL

1. PRIOR TO STARTING ANY OTHER WORK ON THE SITE, THE CONTRACTOR SHALL NOTIFY APPROPRIATE AGENCIES AND SHALL INSTALL EROSION CONTROL MEASURES AS SHOWN ON THE PLANS AND AS IDENTIFIED IN FEDERAL, STATE, AND LOCAL APPROVAL DOCUMENTS PERTAINING TO THIS PROJECT.
2. THE CONTRACTOR SHALL INSPECT AND MAINTAIN EROSION AND SEDIMENT CONTROL MEASURES AND REMOVE SEDIMENT THEREFROM ON A WEEKLY BASIS AND WITHIN 12 HOURS AFTER EACH STORM EVENT AND DISPOSE OF SEDIMENTS AT A LICENSED FACILITY SUCH THAT THEY DO NOT ENCUMBER OTHER DRAINAGE STRUCTURES AND PROTECTED AREAS.
3. THE CONTRACTOR SHALL BE FULLY RESPONSIBLE TO CONTROL CONSTRUCTION SUCH THAT SEDIMENTATION SHALL NOT AFFECT REGULATORY PROTECTED AREAS, WHETHER SUCH SEDIMENTATION IS CAUSED BY WATER, WIND, OR DIRECT DEPOSIT.
4. THE CONTRACTOR SHALL PERFORM CONSTRUCTION SEQUENCING SUCH THAT EARTH MATERIALS ARE EXPOSED FOR A MINIMUM OF TIME BEFORE THEY ARE COVERED, SEEDED, OR OTHERWISE STABILIZED TO PREVENT EROSION.
5. UPON COMPLETION OF CONSTRUCTION AND ESTABLISHMENT OF PERMANENT GROUND COVER, OR OTHER VEGETATION, THE CONTRACTOR SHALL REMOVE AND DISPOSE OF EROSION CONTROL MEASURES AND CLEAN UP SEDIMENT AND DEBRIS FROM THE PROJECT SITE.

EXISTING CONDITIONS

1. THE HORIZONTAL DATUM FOR THIS DRAWING SET IS NAD83 NEW YORK STATE PLANE, LONG ISLAND. THE UNITS ARE IN FEET.
2. THE VERTICAL DATUM FOR THIS DRAWING SET IS NAVD88. THE UNITS ARE IN FEET.
3. THE PROPERTY LINES SHOWN ON THE PLANS WERE SURVEYED BY WILKINSON AND ASSOCIATES IN MARCH OF 2022.
4. THE EXISTING CONDITION TOPOGRAPHIC DATA WITHIN THE PROJECT LIMITS IS BASED ON A GROUND SURVEY BY WILKINSON AND ASSOCIATES IN MARCH 2022.
5. ALL SURVEYED CONTROL POINTS MUST BE PROTECTED FROM DISTURBANCE. IF A CONTROL POINT MUST BE DISTURBED, COORDINATE WITH THE ENGINEER PRIOR TO GRADING.

**NYSDEC
APPROVED AS PER TERMS
AND CONDITIONS OF**

PERMIT NO *1-4730-01079/00002*

DATE: *9/7/2023*

**NEIWPCC, PEP, & TOWN OF RIVERHEAD
MEETINGHOUSE CREEK STORMWATER WETLAND
& HABITAT RESTORATION
AQUEBOGUE, NY**

GENERAL NOTES

| | |
|-------------------|---------------------|
| MYS DRAWN | CC, SW DESIGNED |
| JK, MH CHECKED | - APPROVED |
| 10/07/22 DATE | 20-05-23 PROJECT |



PURPOSE: STORMWATER BMP & HABITAT RESTORATION
IN: MEETINGHOUSE CREEK COUNTY: SUFFOLK STATE: NY
DATE: 10/07/22
SHEET 2 of 17

TOTAL WETLAND AREA WITHIN SUBJECT PARCEL = 49,993 SF 1.15 AC
 TOTAL PHRAGMITES AREA WITHIN SUBJECT PARCEL = 23,031 SF 0.53 AC

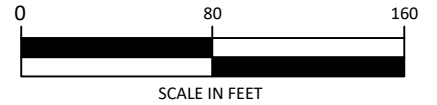

NYSDEC
 APPROVED AS PER TERMS
 AND CONDITIONS OF

PERMIT NO *1-4730-01079/00002*

DATE: *9/7/2023*

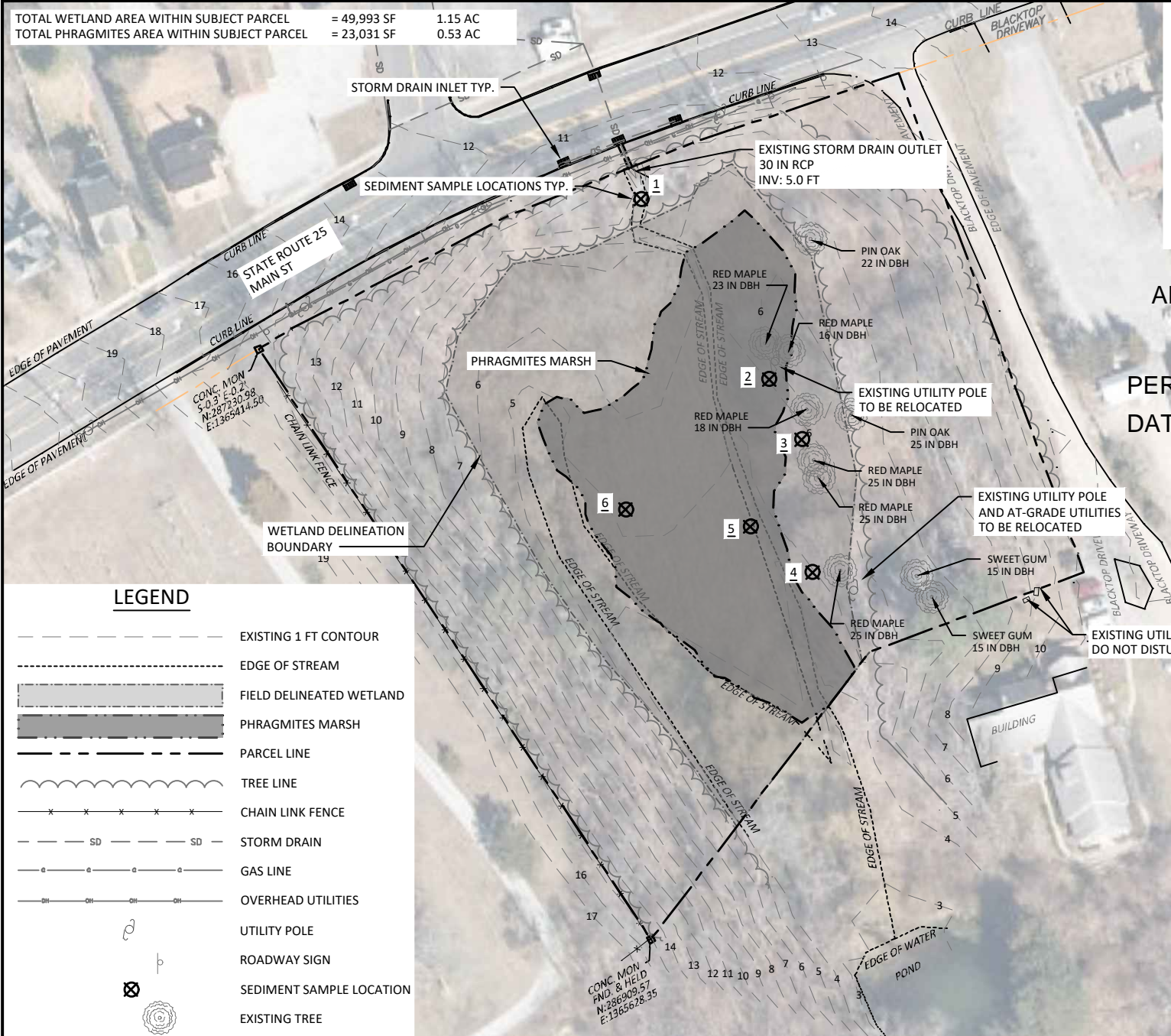

LEGEND

- EXISTING 1 FT CONTOUR
- EDGE OF STREAM
- FIELD DELINEATED WETLAND
- PHRAGMITES MARSH
- PARCEL LINE
- TREE LINE
- CHAIN LINK FENCE
- STORM DRAIN
- GAS LINE
- OVERHEAD UTILITIES
- UTILITY POLE
- ROADWAY SIGN
- SEDIMENT SAMPLE LOCATION
- EXISTING TREE

- NOTES:**
1. TREES SHOWN ON THIS PLAN ARE A SUBSET OF TREES LOCATED ON THE SUBJECT PARCEL. TREES IDENTIFIED ON THIS PLAN MAY BE AFFECTED BY CONSTRUCTION.
 2. WETLAND DELINEATED BY LAND USE ECOLOGICAL SERVICES ON 08/20/21
 3. GROUND AND PROPERTY BOUNDARY SURVEY CONDUCTED BY WILKINSON AND ASSOCIATES ON 02/16/22
 4. RELOCATE ALL UTILITIES IN COORDINATION WITH THE RELEVANT UTILITY COMPANIES, TOWN OF RIVERHEAD, AND OTHER PARTIES AS NECESSARY.

NEIWPC, PEP, & TOWN OF RIVERHEAD
 MEETINGHOUSE CREEK STORMWATER WETLAND
 & HABITAT RESTORATION
 AQUEBOGUE, NY

EXISTING CONDITIONS

| | |
|-------------------|---------------------|
| MYS DRAWN | CC, SW DESIGNED |
| JK, MH CHECKED | - APPROVED |
| 10/07/22 DATE | 20-05-23 PROJECT |

interfluve
 220 Concord Ave, 2nd Floor
 Cambridge, MA 02138
 617.714.5537
 www.interfluve.com

PURPOSE: STORMWATER BMP & HABITAT RESTORATION
 IN: MEETINGHOUSE CREEK COUNTY: SUFFOLK STATE: NY
 DATE: 10/07/22
 SHEET 3 of 17

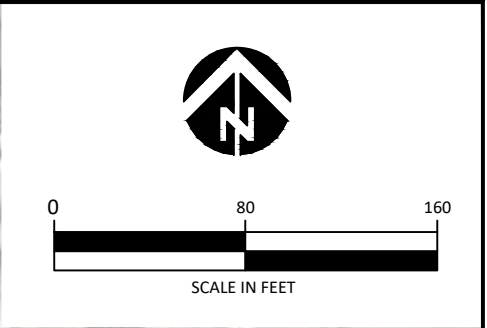
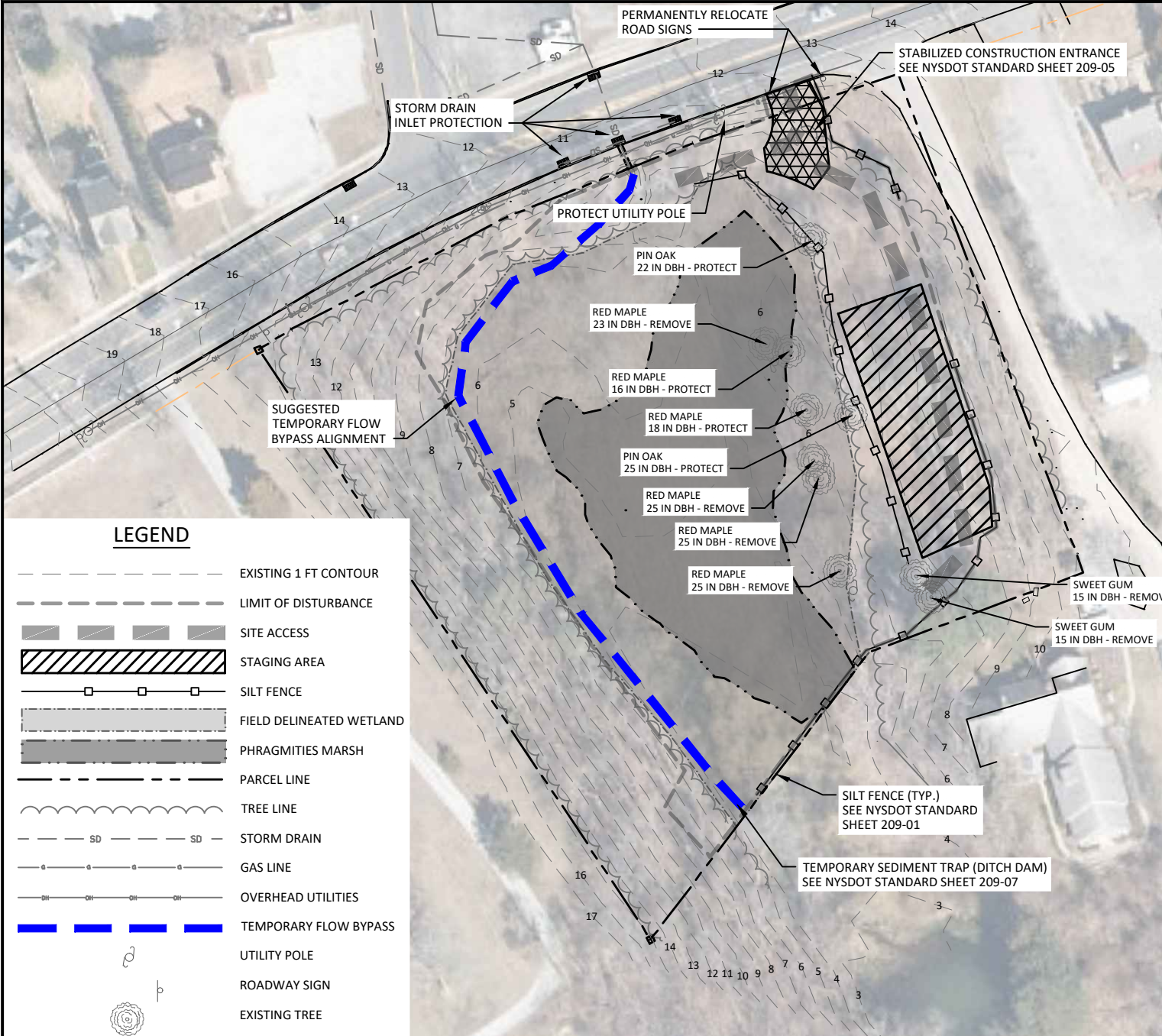

NYSDEC
 APPROVED AS PER TERMS
 AND CONDITIONS OF
 PERMIT NO *1-4730-01079/00002*
 DATE: *9/7/2023*

LEGEND

- EXISTING 1 FT CONTOUR
- LIMIT OF DISTURBANCE
- SITE ACCESS
- STAGING AREA
- SILT FENCE
- FIELD DELINEATED WETLAND
- PHRAGMITIES MARSH
- PARCEL LINE
- TREE LINE
- STORM DRAIN
- GAS LINE
- OVERHEAD UTILITIES
- TEMPORARY FLOW BYPASS
- UTILITY POLE
- ROADWAY SIGN
- EXISTING TREE

SUGGESTED CONSTRUCTION SEQUENCING

1. RELOCATE SIGNS AND UTILITIES AS INDICATED ON THE PLANS AND IN THE SPECIFICATIONS.
2. INSTALL SEDIMENT AND EROSION CONTROL MEASURES
3. IMPLEMENT TRAFFIC CONTROL.
4. CLEAR AND GRUB FOR ACCESS AND STAGING.
5. ESTABLISH TEMPORARY FLOW BYPASS AROUND WETLAND.
6. EXCAVATE DELETERIOUS AND UNSUITABLE MATERIAL AS SPECIFIED IN PLANS.
7. GRADE WETLAND AND CONSTRUCT CHANNEL AND POOLS. COMPLETE MICROTOPOGRAPHY CONCURRENTLY.
8. RELEASE FLOW INTO CHANNEL AND POOLS. DECOMMISSION BYPASS. INSTALL PUMP SYSTEM IN MICROPOOL TO CREATE BYPASS AND MANAGE GROUND MOISTURE CONDITIONS DURING EMBANKMENT CONSTRUCTION.
9. INSTALL PERMANENT WATER CONTROL STRUCTURES AND CONSTRUCT EMBANKMENT AND PERMANENT ACCESS.
10. REMOVE PUMP SYSTEM AND ANY OTHER WATER CONTROL MEASURES.
11. SEED AND INSTALL PLANTINGS.
12. REMOVE SEDIMENT AND EROSION CONTROL MEASURES.

NEIWPC, PEP, & TOWN OF RIVERHEAD
 MEETINGHOUSE CREEK STORMWATER WETLAND
 & HABITAT RESTORATION
 AQUEBOGUE, NY

SITE ACCESS, REMOVALS, AND
 EROSION AND SEDIMENT
 CONTROL

| | |
|-------------------|---------------------|
| MYS DRAWN | CC, SW DESIGNED |
| JK, MH CHECKED | - APPROVED |
| 10/07/22 DATE | 20-05-23 PROJECT |



PURPOSE: STORMWATER BMP &
 HABITAT RESTORATION
 IN: MEETINGHOUSE CREEK
 COUNTY: SUFFOLK STATE: NY
 DATE: 10/07/22
 SHEET 4 of 17

TOTAL EXISTING WETLAND AREA WITHIN SUBJECT PARCEL = 49,993 SF 1.15 AC
 TOTAL EXISTING PHRAGMITES AREA WITHIN SUBJECT PARCEL = 23,031 SF 0.53 AC
 TOTAL PROPOSED WETLAND AREA WITHIN SUBJECT PARCEL = 57,354 SF 1.32 AC

TOTAL CUT VOLUME: 3,300 CY

TOTAL FILL VOLUME: 1,740 CY

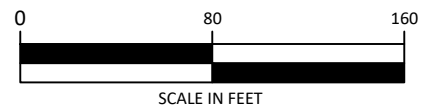
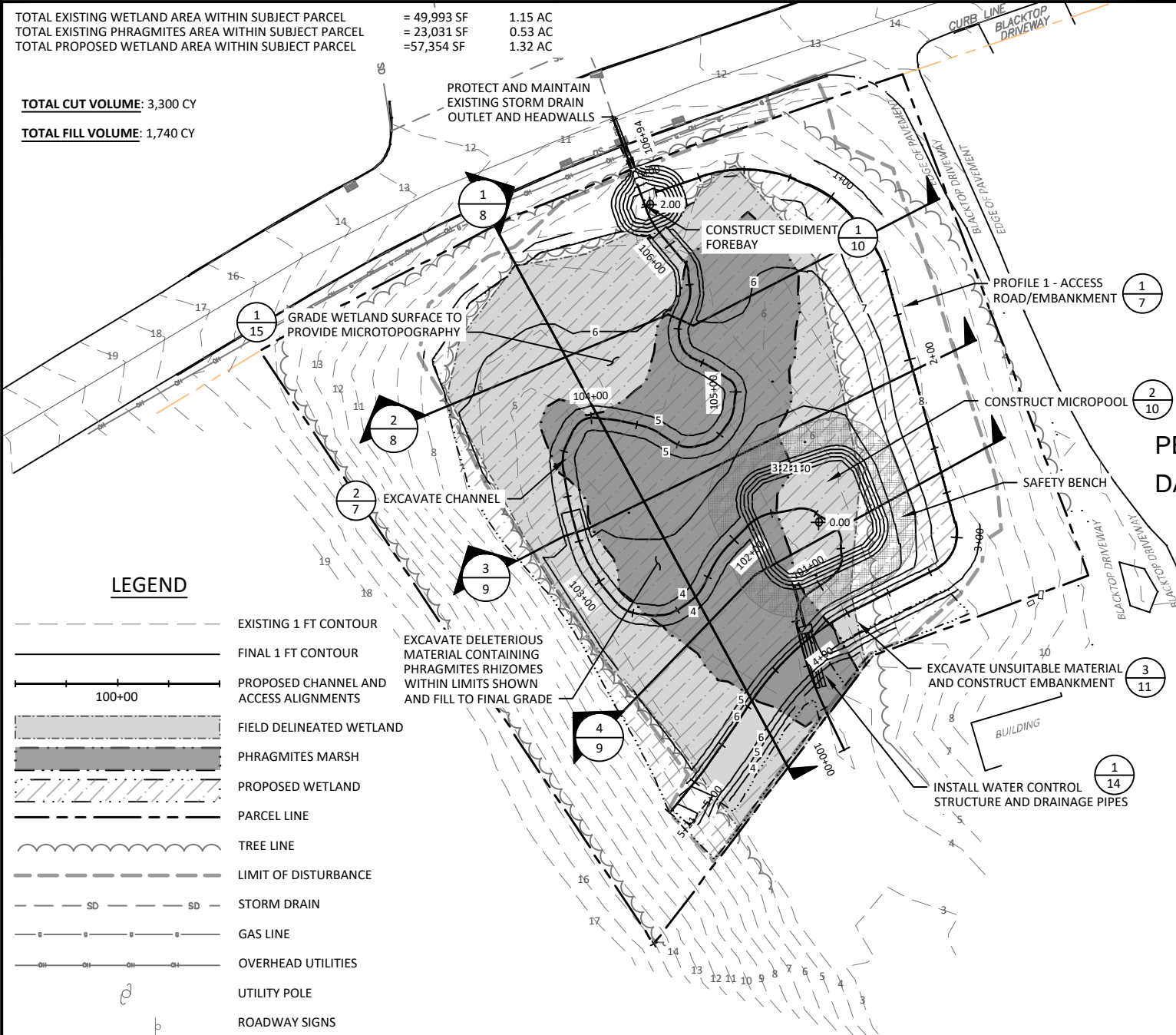

NYSDEC
APPROVED AS PER TERMS
AND CONDITIONS OF
PERMIT NO 1-4730-01079/00002
DATE: 9/7/2023

LEGEND

- EXISTING 1 FT CONTOUR
- FINAL 1 FT CONTOUR
- PROPOSED CHANNEL AND ACCESS ALIGNMENTS
- FIELD DELINEATED WETLAND
- PHRAGMITES MARSH
- PROPOSED WETLAND
- PARCEL LINE
- TREE LINE
- LIMIT OF DISTURBANCE
- STORM DRAIN
- GAS LINE
- OVERHEAD UTILITIES
- UTILITY POLE
- ROADWAY SIGNS

EXCAVATE DELETERIOUS MATERIAL CONTAINING PHRAGMITES RHIZOMES WITHIN LIMITS SHOWN AND FILL TO FINAL GRADE

NOTES:

1. CONDUCT EARTHWORK IN CONDITIONS FREE OF ACTIVELY FLOWING WATER.
2. CONTROL MOISTURE CONDITIONS TO ACHIEVE FILL COMPACTION REQUIREMENTS.
3. REQUIRED DEPTH OF DELETERIOUS MATERIAL EXCAVATION IS EXPECTED TO BE APPROXIMATELY 18 INCHES WITHIN PHRAGMITES MARSH. ACTUAL DEPTH MAY VARY. REMOVAL OF DELETERIOUS MATERIAL SHALL BE CONFIRMED ON SITE BY THE ENGINEER PRIOR TO PLACEMENT OF FILL.
4. DEPTH OF UNSUITABLE MATERIAL EXCAVATION IS EXPECTED TO BE 24 INCHES.
5. DELETERIOUS MATERIAL IS DEFINED AS SOIL CONTAINING VIABLE PROPAGULES OF INVASIVE PLANTS, WOODY VEGETATION AND STUMPS, ROOTS, BRUSH, REFUSE, STONES, CLAY LUMPS, OR SIMILAR OBJECTS.
6. UNSUITABLE MATERIAL IS DEFINED IN SECTION 203-1.03 OF THE NYS DOT STANDARD SPECIFICATIONS.
7. EXCAVATED MATERIAL SHALL BE DISPOSED OF OFFSITE IN ACCORDANCE WITH ALL APPLICABLE LAWS AND REGULATIONS.

NEIWPC, PEP, & TOWN OF RIVERHEAD
MEETINGHOUSE CREEK STORMWATER WETLAND
& HABITAT RESTORATION
AQUEBOGUE, NY

GRADING PLAN

| | |
|-------------------|---------------------|
| MYS DRAWN | CC, SW DESIGNED |
| JK, MH CHECKED | - APPROVED |
| 10/07/22 DATE | 20-05-23 PROJECT |

220 Concord Ave, 2nd Floor
 Cambridge, MA 02138
 617.714.5537
 www.interfluve.com

PURPOSE: STORMWATER BMP & HABITAT RESTORATION
 IN: MEETINGHOUSE CREEK COUNTY: SUFFOLK STATE: NY
 DATE: 10/07/22
 SHEET 5 of 17















ROCK QUANTITIES

- ROCK TYPE - A = 100 CY
- ROCK TYPE - B = 240 CY
- ROCK TYPE - C = 120 CY

ROCK SIZING

- ROCK TYPE - A: ROUNDED STREAMBED MATERIAL, D50 = 2 IN
- ROCK TYPE - B: RIPRAP, D50= 6 IN
- ROCK TYPE - C: RIPRAP, D50 = 12 IN

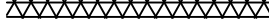
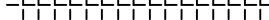
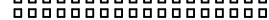
LEGEND

-  EXISTING 1 FT CONTOUR
-  PROPOSED 1 FT CONTOUR
-  PARCEL LINE
-  TREE LINE
-  STORM DRAIN
-  GAS LINE
-  OVERHEAD UTILITIES
-  LIMIT OF DISTURBANCE
-  LIMIT OF EXCAVATION
-  EXISTING DELINEATED WETLAND
-  PROPOSED WETLAND
-  PERMANENT ENTRANCE
-  ACCESS ROAD
-  SURFACE FABRIC
-  ROCK - TYPE A
-  ROCK TYPE B AND TYPE C
-  FABRIC ENCAPSULATED SOIL LIFTS

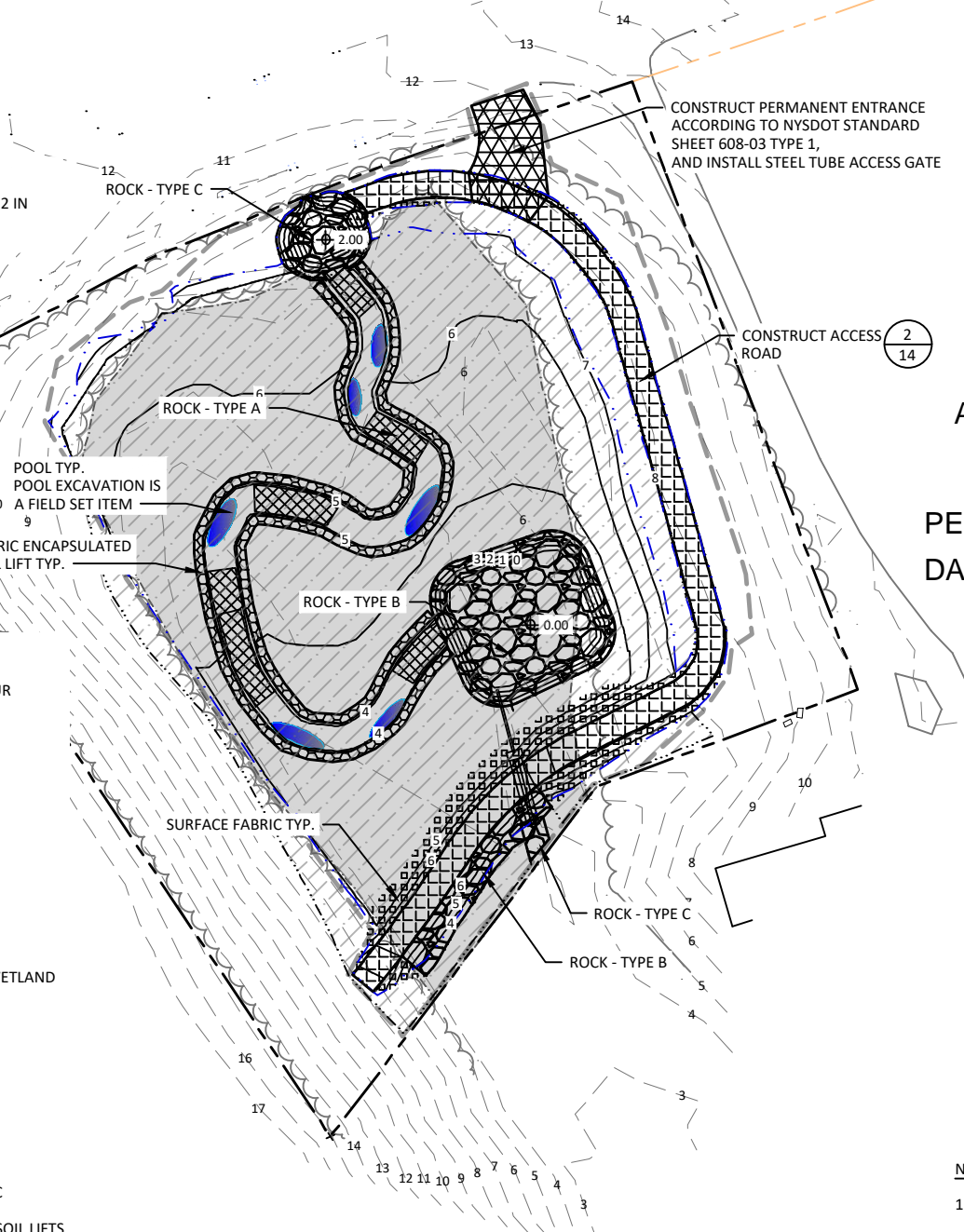

NYSDEC
 APPROVED AS PER TERMS
 AND CONDITIONS OF
 PERMIT NO *1-4730-01079/00002*
 DATE: *9/7/2023*

- NOTES:**
1. FIELD-SET ITEMS ARE ITEMS SET IN THE FIELD IN COORDINATION WITH THE ENGINEER.

NEIWPC, PEP, & TOWN OF RIVERHEAD
 MEETINGHOUSE CREEK STORMWATER WETLAND
 & HABITAT RESTORATION
 AQUEBOGUE, NY

SURFACE TREATMENT PLAN

| | |
|-------------------|---------------------|
| MYS DRAWN | CC, SW DESIGNED |
| JK, MH CHECKED | - APPROVED |
| 10/07/22 DATE | 20-05-23 PROJECT |



220 Concord Ave, 2nd Floor
 Cambridge, MA 02138
 617.714.5537
 www.interfluve.com

PURPOSE: STORMWATER BMP &
 HABITAT RESTORATION
 IN: MEETINGHOUSE CREEK
 COUNTY: SUFFOLK STATE: NY
 DATE: 10/07/22
 SHEET 6 of 17

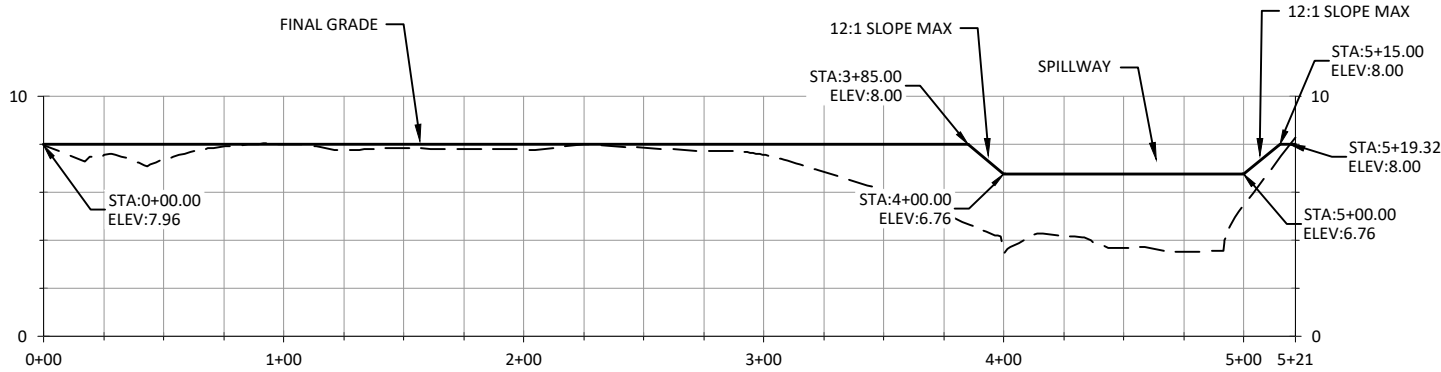

PROFILE 1 - ACCESS ROAD/EMBANKMENT

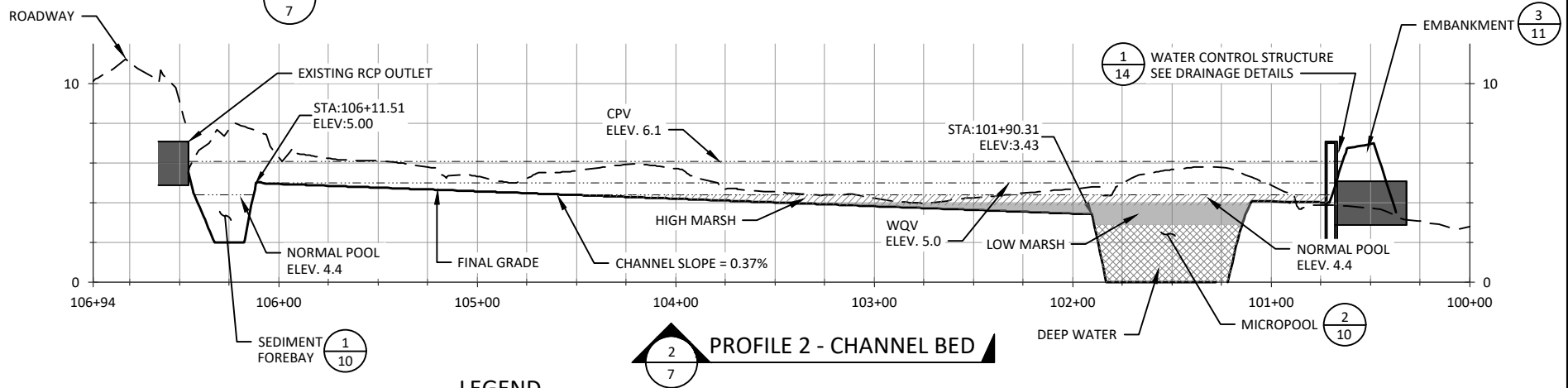

PROFILE 2 - CHANNEL BED

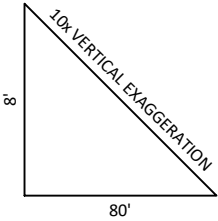

LEGEND

| | |
|--|-----------------------|
| | EXISTING GRADE |
| | FINAL GRADE NEAT LINE |
| | DESIGN WSE |
| | HIGH MARSH |
| | LOW MARSH |
| | DEEP WATER |

**NYSDEC
APPROVED AS PER TERMS
AND CONDITIONS OF**

PERMIT NO 1-4730-01079/00002
DATE: 9/7/2023

DEFINITIONS
CPV: CHANNEL PROTECTION VOLUME ABOVE NORMAL POOL.
WQV: WATER QUALITY VOLUME ABOVE NORMAL POOL

**NEIWPC, PEP, & TOWN OF RIVERHEAD
MEETINGHOUSE CREEK STORMWATER WETLAND
& HABITAT RESTORATION
AQUEBOGUE, NY**

GRADING PROFILES

| | |
|-------------------|---------------------|
| MYS DRAWN | CC, SW DESIGNED |
| JK, MH CHECKED | - APPROVED |
| 10/07/22 DATE | 20-05-23 PROJECT |

220 Concord Ave, 2nd Floor
Cambridge, MA 02138
617.714.5537
www.interfluve.com

PURPOSE: STORMWATER BMP & HABITAT RESTORATION
IN: MEETINGHOUSE CREEK COUNTY: SUFFOLK STATE: NY
DATE: 10/07/22
SHEET 7 OF 17

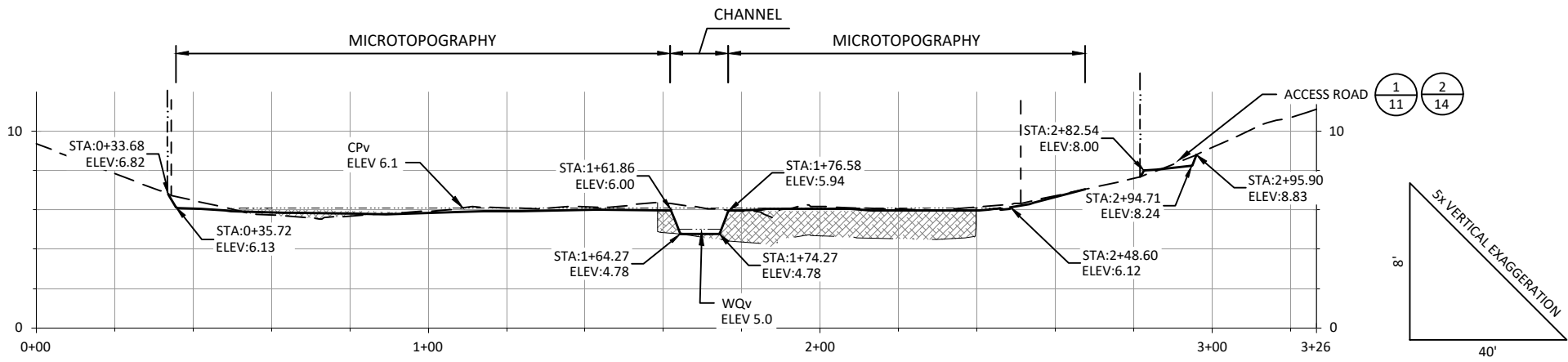
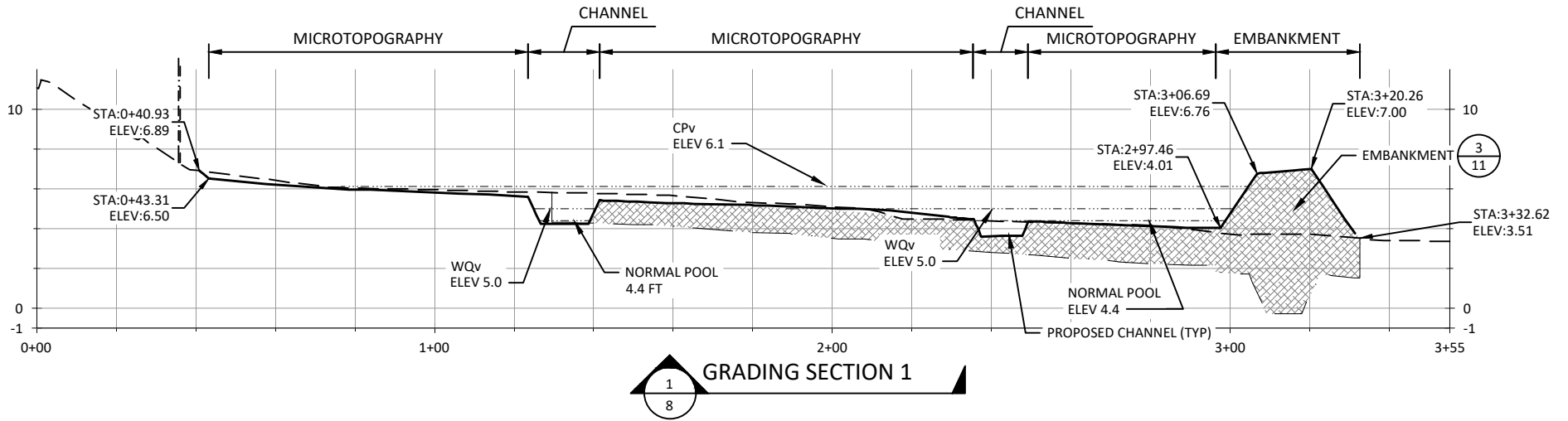

GRADING SECTION 2

**NYSDEC
APPROVED AS PER TERMS
AND CONDITIONS OF**

PERMIT NO 1-4730-01079/00002
DATE: 9/7/2023

LEGEND

- EXISTING GRADE
- FINAL GRADE NEAT LINE
- - - - - APPROXIMATE EXCAVATION DEPTH OF DELETERIOUS AND UNSUITABLE MATERIAL
- DESIGN WSE
- ▨ FILL
- - - - - FIELD DELINEATED WETLAND EXTENTS
- - - - - PROPOSED WETLAND EXTENTS

DEFINITIONS

CPV: CHANNEL PROTECTION VOLUME ABOVE NORMAL POOL.
WQV: WATER QUALITY VOLUME ABOVE NORMAL POOL

**NEIWPC, PEP, & TOWN OF RIVERHEAD
MEETINGHOUSE CREEK STORMWATER WETLAND
& HABITAT RESTORATION
AQUEBOGUE, NY**

GRADING SECTIONS (1 OF 2)

| | |
|-------------------|---------------------|
| MYS DRAWN | CC, SW DESIGNED |
| JK, MH CHECKED | - APPROVED |
| 10/07/22 DATE | 20-05-23 PROJECT |



PURPOSE: STORMWATER BMP & HABITAT RESTORATION
IN: MEETINGHOUSE CREEK COUNTY: SUFFOLK STATE: NY
DATE: 10/07/22
SHEET 8 OF 17

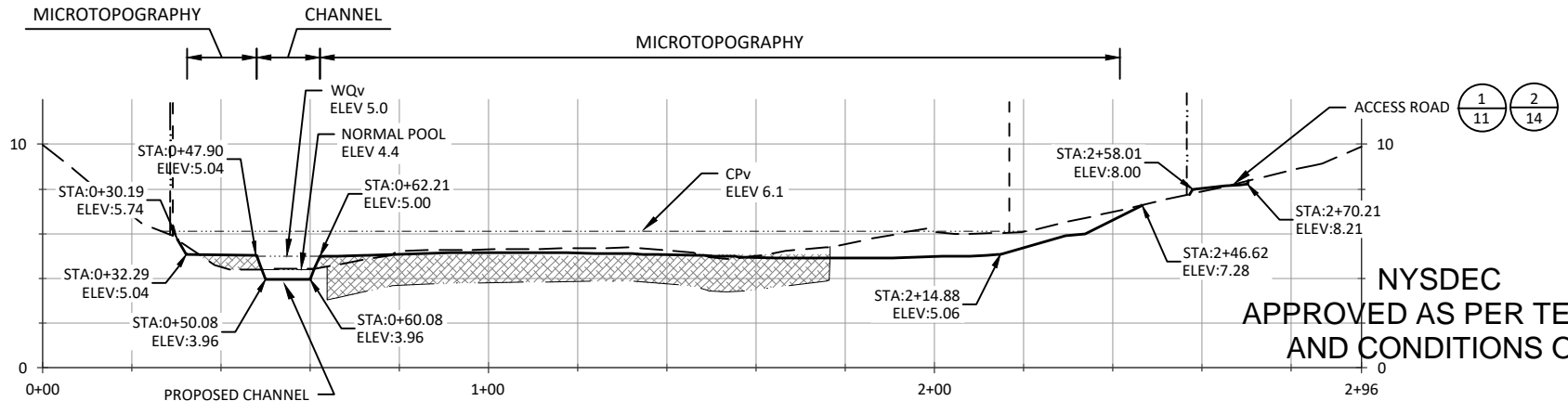

NYSDEC
APPROVED AS PER TERMS
AND CONDITIONS OF
PERMIT NO 1-4730-01079/00002
DATE: 9/7/2023

3
GRADING SECTION 3
9

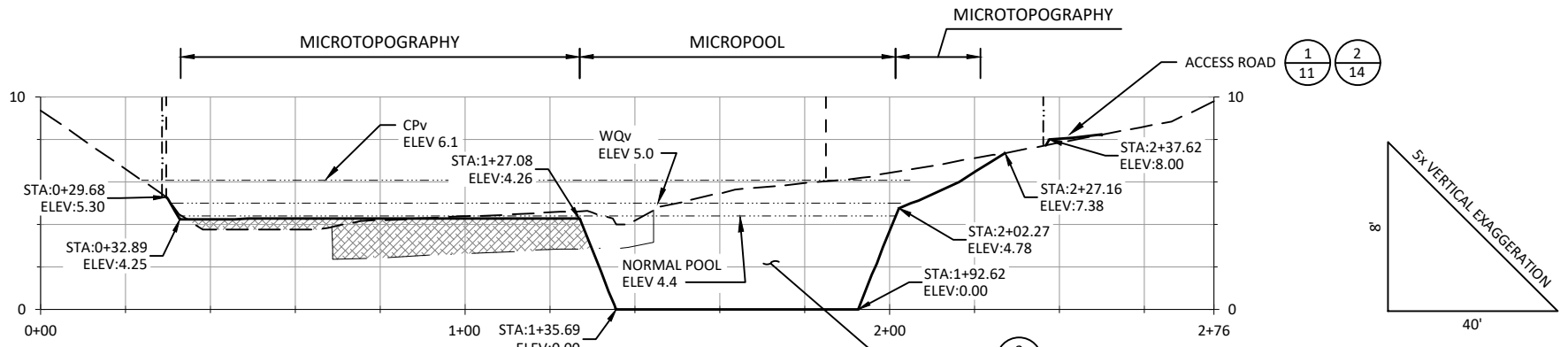

4
GRADING SECTION 4
9

DEFINITIONS

CPV: CHANNEL PROTECTION VOLUME ABOVE NORMAL POOL.
 WQV: WATER QUALITY VOLUME ABOVE NORMAL POOL

LEGEND

- EXISTING GRADE
- FINAL GRADE NEAT LINE
- - - - - APPROXIMATE EXCAVATION DEPTH OF DELETERIOUS AND UNSUITABLE MATERIAL
- DESIGN WSE
- [Hatched Box] FILL
- - - - - FIELD DELINEATED WETLAND EXTENTS
- PROPOSED WETLAND EXTENTS

NEIWPCC, PEP, & TOWN OF RIVERHEAD
MEETINGHOUSE CREEK STORMWATER WETLAND
& HABITAT RESTORATION
AQUEBOGUE, NY

GRADING SECTIONS (2 OF 2)

| | |
|-------------------|---------------------|
| MYS DRAWN | CC, SW DESIGNED |
| JK, MH CHECKED | - APPROVED |
| 10/07/22 DATE | 20-05-23 PROJECT |



PURPOSE: STORMWATER BMP & HABITAT RESTORATION
 IN: MEETINGHOUSE CREEK COUNTY: SUFFOLK STATE: NY
 DATE: 10/07/22
 SHEET 9 OF 17

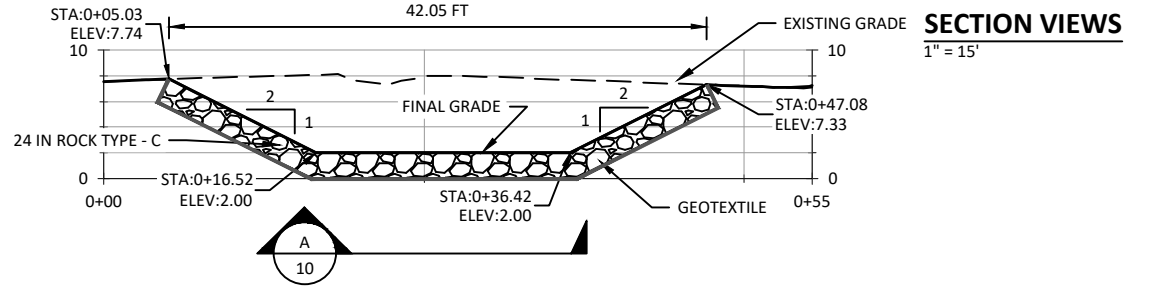
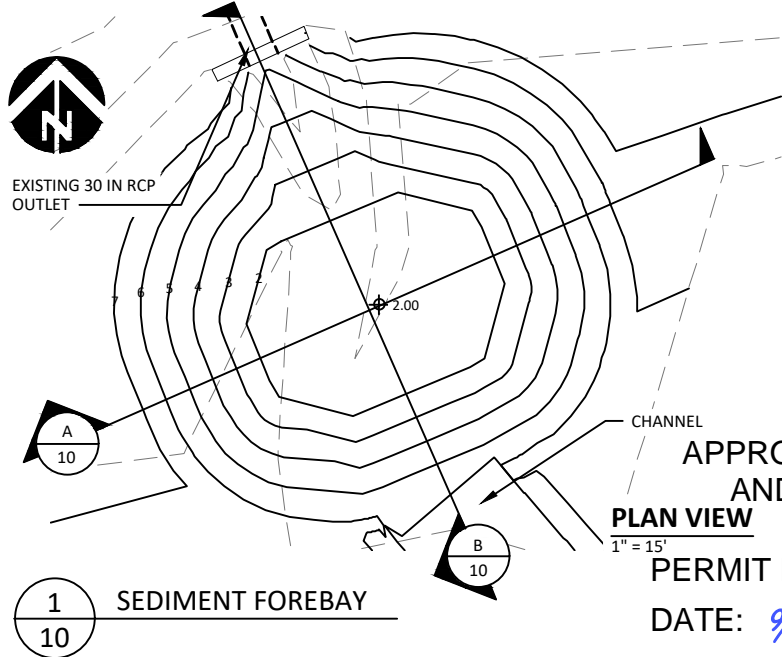

NYSDEC
APPROVED AS PER TERMS
AND CONDITIONS OF
PERMIT NO 1-4730-01079/00002
DATE: 9/7/2023

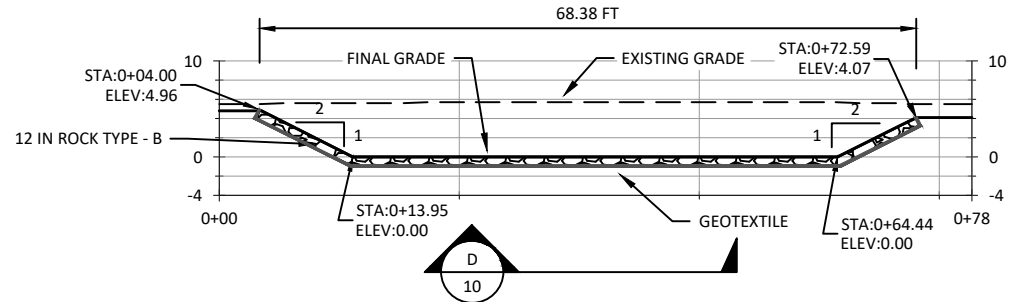
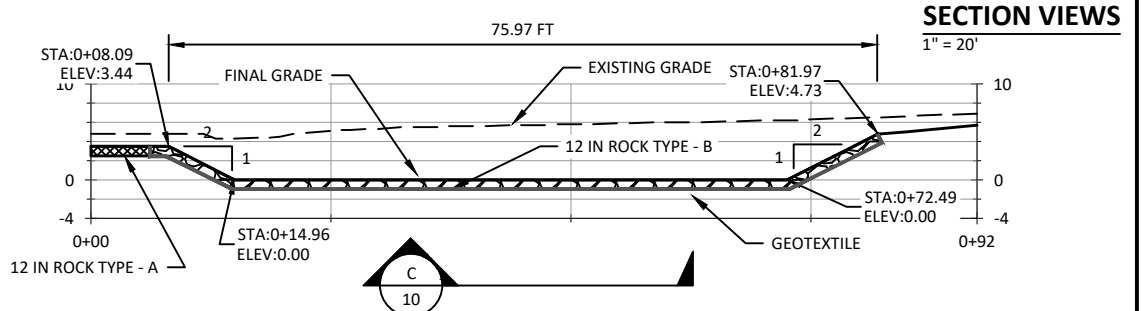
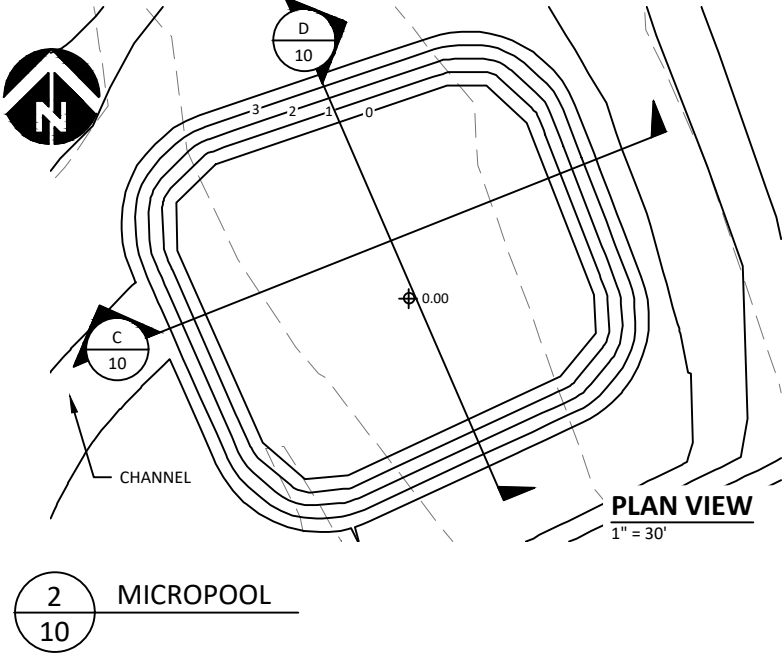
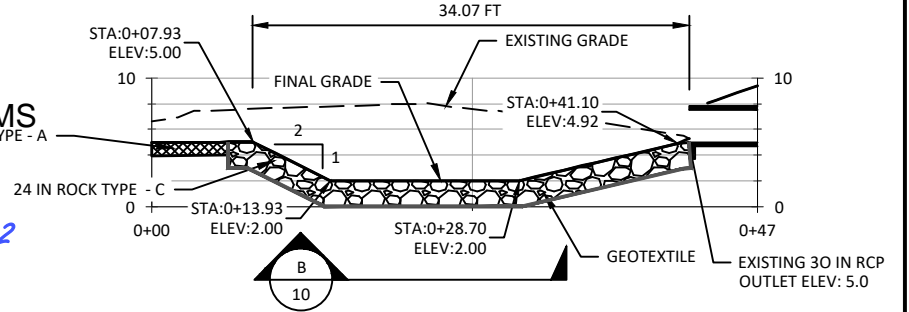

NEIWPC, PEP, & TOWN OF RIVERHEAD
MEETINGHOUSE CREEK STORMWATER WETLAND
& HABITAT RESTORATION
AQUEBOGUE, NY

TYPICAL CONSTRUCTION SECTION
(1 OF 2)

| | |
|-------------------|---------------------|
| MYS DRAWN | CC, SW DESIGNED |
| JK, MH CHECKED | - APPROVED |
| 10/07/22 DATE | 20-05-23 PROJECT |



PURPOSE: STORMWATER BMP & HABITAT RESTORATION
IN: MEETINGHOUSE CREEK
COUNTY: SUFFOLK STATE: NY
DATE: 10/07/22
SHEET 10 of 17

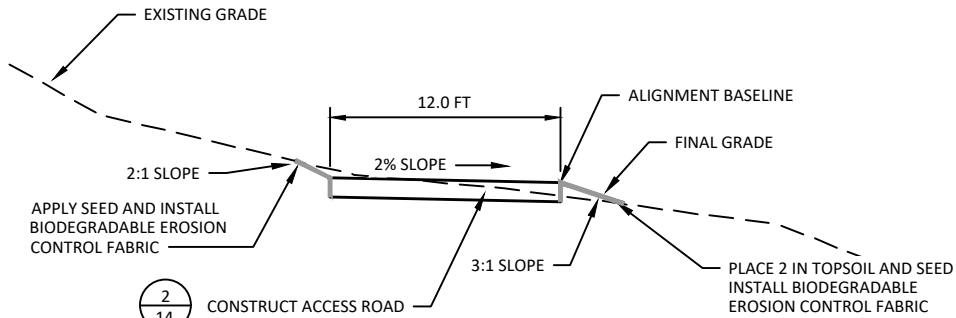

1
11 TYPICAL ACCESS ROAD SECTION
1" = 10'

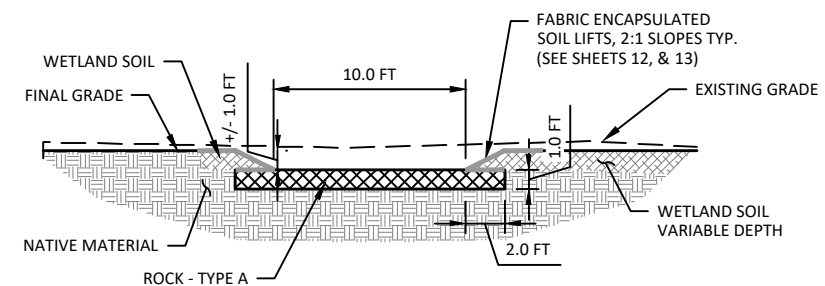

CHANNEL SECTION WITH ROCK TYPE - A

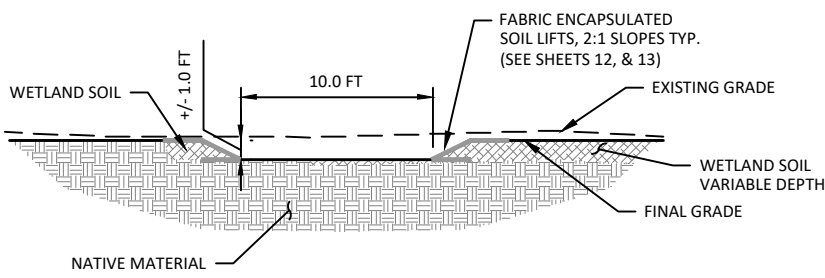

2
11 TYPICAL CHANNEL SECTIONS
1" = 10'

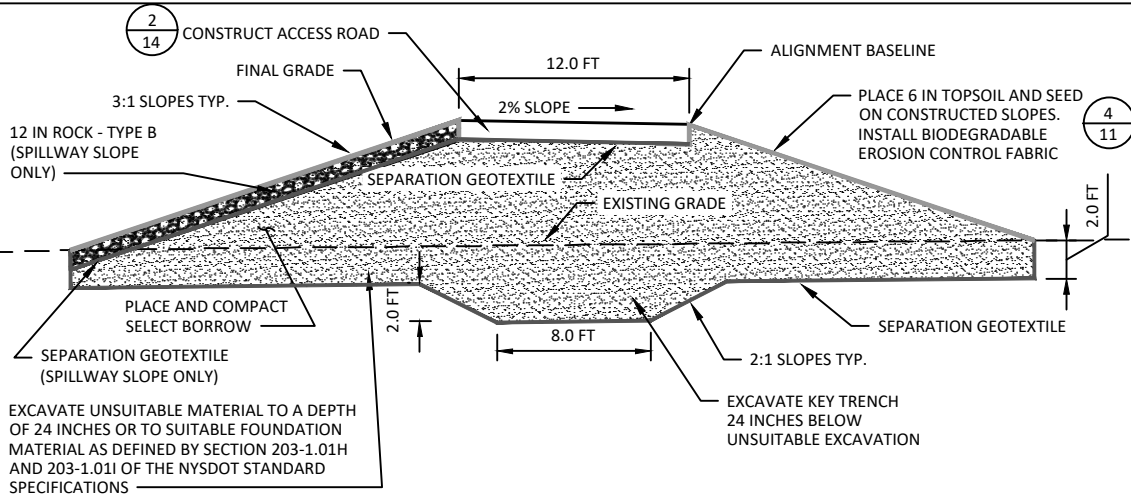

3
11 TYPICAL EMBANKMENT SECTION
1" = 10'

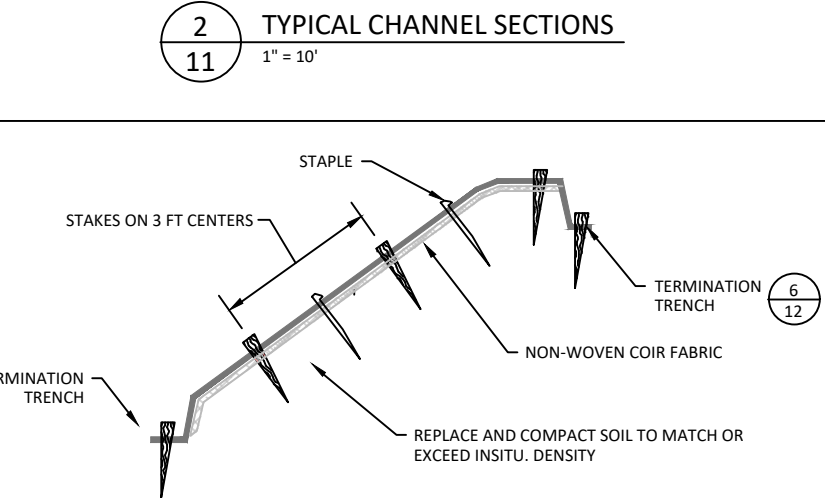

4
11 EMBANKMENT DETAIL - FABRIC COVERED SLOPE
NOT TO SCALE

NYSDEC
APPROVED AS PER TERMS
AND CONDITIONS OF
PERMIT NO **1-4730-01079/00002**
DATE: **9/7/2023**

NEIWPC, PEP, & TOWN OF RIVERHEAD
MEETINGHOUSE CREEK STORMWATER WETLAND
& HABITAT RESTORATION
AQUEBOGUE, NY

TYPICAL CONSTRUCTION
SECTIONS (2 OF 2)

| | |
|-------------------|---------------------|
| MYS DRAWN | CC, SW DESIGNED |
| JK, MH CHECKED | - APPROVED |
| 10/07/22 DATE | 20-05-23 PROJECT |



PURPOSE: STORMWATER BMP &
HABITAT RESTORATION
IN: MEETINGHOUSE CREEK
COUNTY: SUFFOLK STATE: NY
DATE: 10/07/22
SHEET 11 of 17

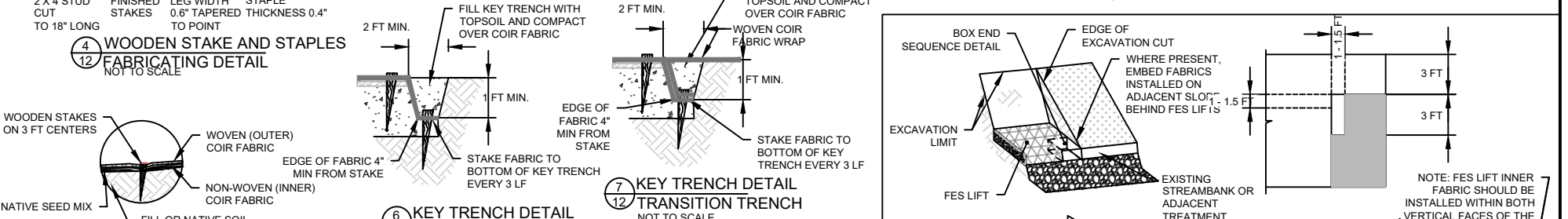
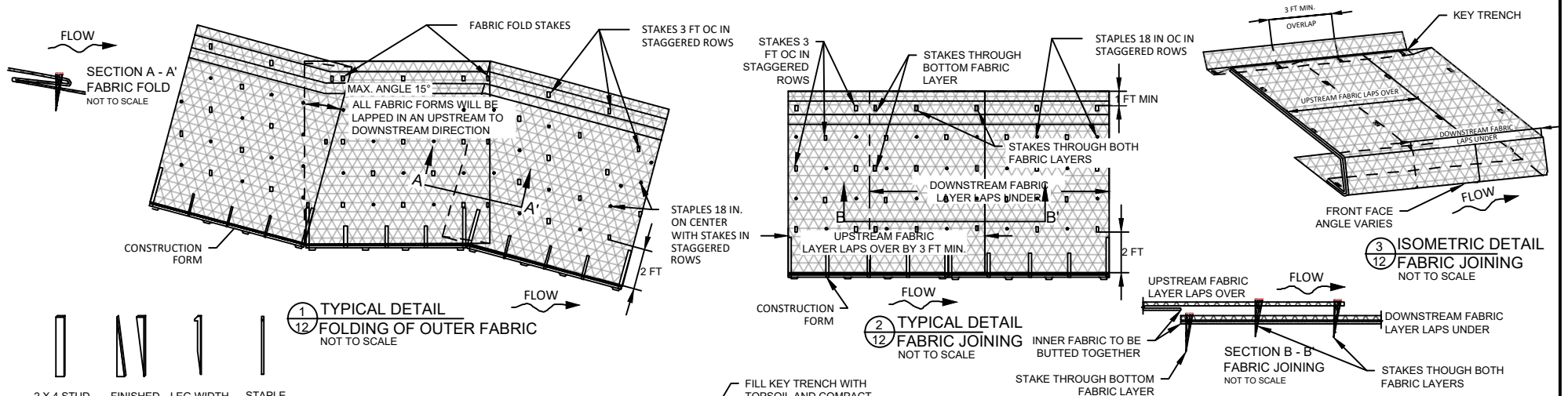

NYSDEC
APPROVED AS PER TERMS AND CONDITIONS OF

PERMIT NO 1-4730-01079/00002

DATE: 9/7/2023

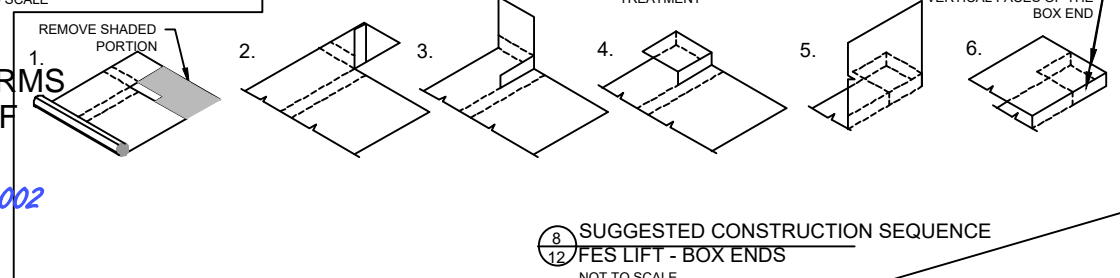

GENERAL NOTES ON SECURING COIR FABRIC

1. SECURE THE OUTER FABRIC (WOVEN, WHERE APPLICABLE), WITH A WOODEN STAKE THROUGH THE FABRIC ON 3 FT CENTERS (SEE DETAIL VIEWS 1 - 3)
NOTE: THE HOLES FOR STAKES SHALL NOT BE PRECUT. ALLOW THE STAKE TO BREAK THE MINIMUM NUMBER OF STRANDS AS IT IS BEING DRIVEN IN. DRIVE STAKES SO THAT 2" TO 3" OF THE TOP OF THE STAKE IS LEFT EXPOSED.
2. OUTER FABRIC ENDS SHALL BE JOINED BY LAPPING THE UPSTREAM PIECE OF FABRIC OVER THE DOWNSTREAM PIECE AS SHOWN IN DETAILS 1-3. OVERLAPS SHALL BE A MINIMUM OF 3 FT. INNER FABRIC ENDS SHALL BE BUTTED TOGETHER, NOT OVERLAPPED. OVERLAPS SHALL BE STAGGERED FROM LIFT TO LIFT BY A MINIMUM OF 15 FT.
3. STAKING SPACING IS DEFINED IN SPECIFICATIONS FOR FES LIFT AND SURFACE FABRIC.

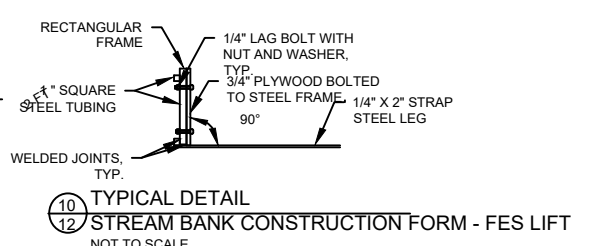
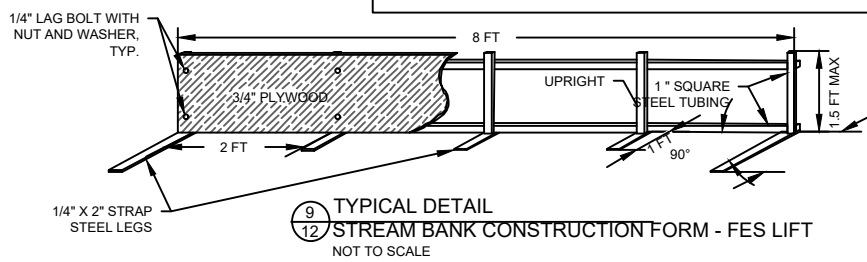

NEIWPCC, PEP, & TOWN OF RIVERHEAD
MEETINGHOUSE CREEK STORMWATER WETLAND
& HABITAT RESTORATION
AQUEBOGUE, NY

FABRIC ENCAPSULATED SLOPE
LIFTS DETAILS (1 OF 2)

| | |
|-------------------|---------------------|
| MYS DRAWN | CC, SW DESIGNED |
| JK, MH CHECKED | - APPROVED |
| 10/07/22 DATE | 20-05-23 PROJECT |

220 Concord Ave, 2nd Floor
Cambridge, MA 02138
617.714.5537
www.interfluve.com

PURPOSE: STORMWATER BMP & HABITAT RESTORATION
IN: MEETINGHOUSE CREEK
COUNTY: SUFFOLK STATE: NY
DATE: 10/07/22
SHEET 12 of 17

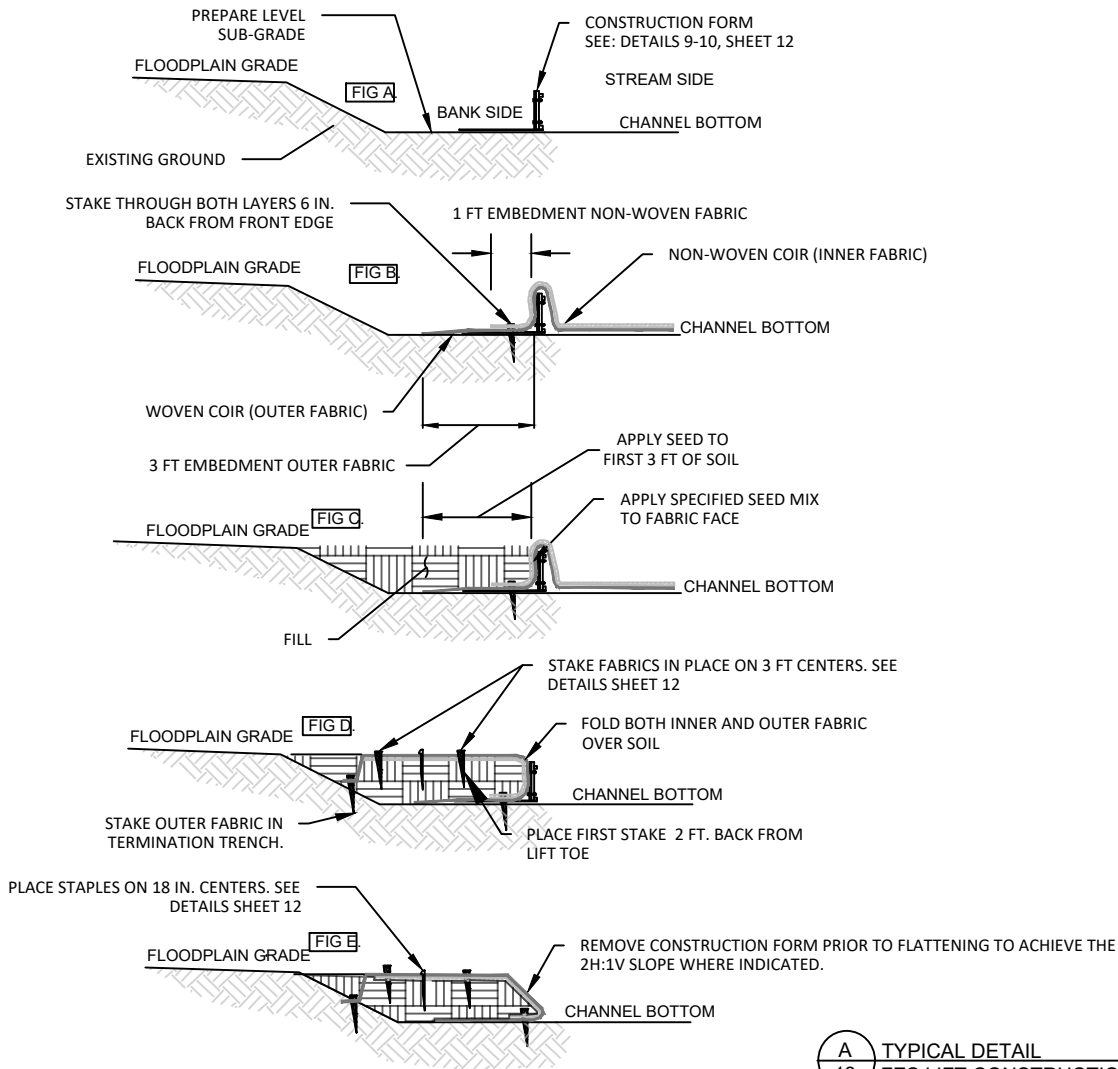

A
13 TYPICAL DETAIL
FES LIFT CONSTRUCTION SEQUENCE
NOT TO SCALE

GENERAL INSTRUCTIONS FOR FABRIC ENCAPSULATED LIFTS

1. BANKS MAY BE CONSTRUCTED IN EITHER AN UPSTREAM OR DOWNSTREAM DIRECTION, AS LONG AS THE FABRIC IS OVERLAPPED IN THE PROPER DIRECTION.
2. PLACE A SERIES OF THREE OR MORE FORMS ON THE GROUND SO THAT THE FORMS FOLLOW THE PROPOSED STREAM BANK ALIGNMENT. BUTT THE ENDS OF THE FORMS TIGHTLY TOGETHER.
3. UNROLL THE OUTER FABRIC PARALLEL TO THE LONG AXIS OF THE CHANNEL AND POSITION IT SO THAT 3 FEET EXTENDS FOR EMBEDMENT ON THE BANK SIDE OF THE FORMS (FIG B), AND A MINIMUM 3 FEET EXTENDS LENGTHWISE BEYOND THE LAST FORM FOR OVERLAP. DRAPE THE REMAINDER OF THE FABRIC OVER THE TOP OF THE FORMS ON THE STREAM SIDE (FIG B).
4. UNROLL THE INNER FABRIC OVER THE TOP OF THE WOVEN COIR FABRIC (FIG B) AND POSITION IT SO THAT AT LEAST 1 FOOT OF THE INNER FABRIC EXTENDS AS AN EMBEDMENT LENGTH ON THE BANK SIDE OF THE FORMS (FIG B). DRAPE THE REMAINDER OF THE FABRIC OVER THE TOP OF THE FORMS ON THE STREAM SIDE AND ALIGN THE LONG EDGES OF THE FABRICS. STRETCH AND PULL THE FABRIC LAYERS TO REMOVE WRINKLES.
5. APPLY SPECIFIED SEED MIX TO INNER FABRIC ALONG VERTICAL EDGE OF LIFT (FIG C). PLACE FILL OVER THE FABRIC ON THE BANK SIDE OF THE FORMS. LEVEL THE FILL AND COMPACT TO 85-90 PERCENT RELATIVE COMPACTION (FIG C).
6. APPLY SPECIFIED SEED MIX TO TOP OF FILL FROM THE FRONT OF THE LIFT TO 3 FT BACK FROM FRONT OF THE LIFT (FIG C).
7. FOLD THE LOOSE ENDS OF THE TWO COIR FABRIC LAYERS BACK OVER THE COMPACTED FILL MATERIAL AND STRETCH TIGHTLY TO REMOVE WRINKLES (FIG D). SECURE WITH WOODEN STAKES 1 PER 3 LF ALONG THE BACK EDGE AND INTO UNDISTURBED SOIL.
8. WHERE THE TOP OF THE LIFT MEETS THE GROUND SURFACE, EXCAVATE A KEY TRENCH 1.5 FEET WIDE AND 1 FOOT DEEP ALONG THE EDGE OF THE OUTER FABRIC LAYER, PARALLEL TO THE FORMS. SEED ENTIRE AREA OF TOP LIFT. SECURE FABRIC IN THE KEY TRENCH WITH WOODEN STAKES, 3 FT O.C. (FIG D)
9. BACKFILL THE KEY TRENCH WITH TOPSOIL AND CONTINUE TO APPLY FILL TO SMOOTHLY MERGE WITH EXISTING CONTOURS. APPLY SPECIFIED SEED MIX TO KEY TRENCH AREA. (FIG D)
10. SUPPLEMENT LIFT STAKING WITH ADDITIONAL WOODEN STAPLES ON 18" CENTERS EXCEPT WHERE WOODEN STAKES HAVE ALREADY BEEN PLACED. REMOVE THE FORMS FROM THE FRONT OF THE COMPLETED LIFT AND FLATTEN FACE (FIG E).

NYSDEC
APPROVED AS PER TERMS
AND CONDITIONS OF

PERMIT NO *1-4730-01079/00002*

DATE: *9/7/2023*

NEIWPC, PEP, & TOWN OF RIVERHEAD
MEETINGHOUSE CREEK STORMWATER WETLAND
& HABITAT RESTORATION
AQUEBOGUE, NY

FABRIC ENCAPSULATED SLOPE
LIFTS DETAILS (2 OF 2)

| | |
|-------------------|---------------------|
| MYS DRAWN | CC, SW DESIGNED |
| JK, MH CHECKED | - APPROVED |
| 10/07/22 DATE | 20-05-23 PROJECT |



PURPOSE: STORMWATER BMP & HABITAT RESTORATION
IN: MEETINGHOUSE CREEK
COUNTY: SUFFOLK STATE: NY
DATE: 10/07/22
SHEET 13 of 17

1
14 DRAINAGE DETAILS
1" = 10'

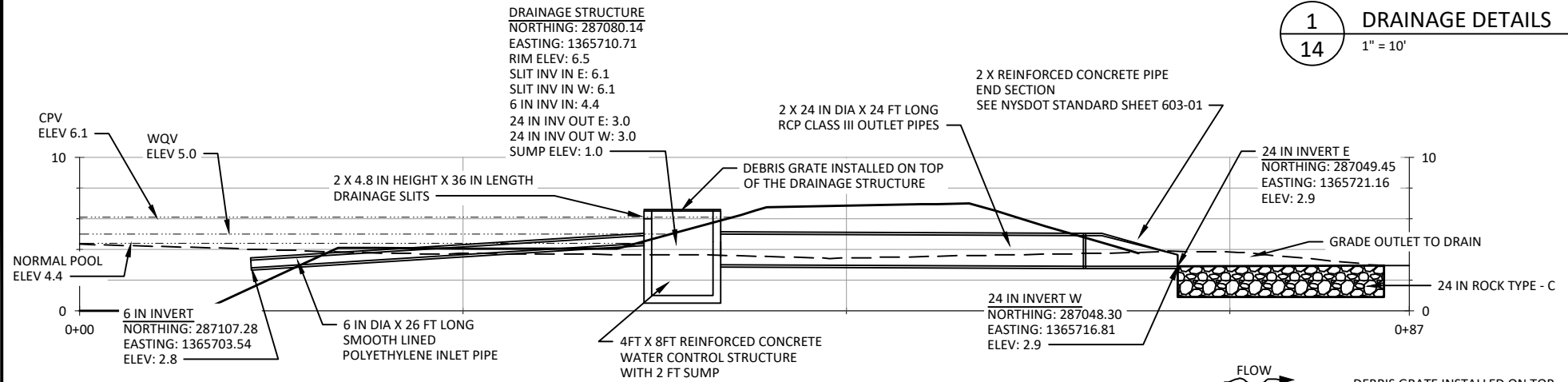

- NOTES**
- ALL PIPE RUNS SHALL BE PLACED TO THE REQUIRED ELEVATIONS WITHIN $\frac{3}{8}$ IN TOLERANCE
 - INSTALL PIPE TIES ON THE LAST 2 JOINTS OF ALL PIPE RUNS

DEFINITIONS

CPV: CHANNEL PROTECTION VOLUME ABOVE NORMAL POOL.

WQV: WATER QUALITY VOLUME ABOVE NORMAL POOL

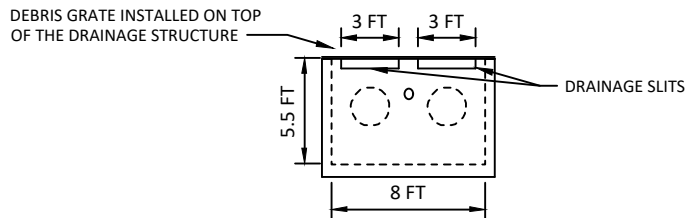

DRAINAGE STRUCTURE ELEVATION VIEW

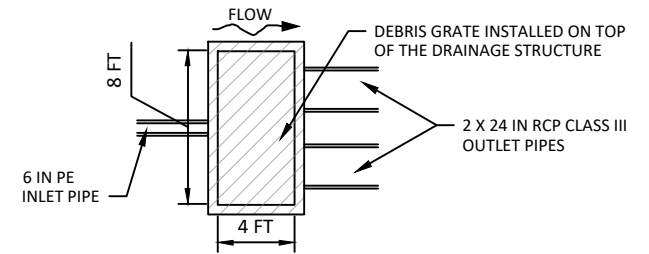

DRAINAGE STRUCTURE PLAN VIEW

INSTALL PERVIOUS PAVING WITH MINIMUM 40% OPENING. DETAILS TO BE DETERMINED

NYSDEC
APPROVED AS PER TERMS
AND CONDITIONS OF

PERMIT NO *1-4730-01079/00002*
DATE: *9/7/2023*

2
14 SITE ACCESS SURFACING
1" = 10'

NEIWPC, PEP, & TOWN OF RIVERHEAD
MEETINGHOUSE CREEK STORMWATER WETLAND
& HABITAT RESTORATION
AQUEBOGUE, NY

DRAINAGE & SITE ACCESS DETAILS

| | |
|-------------------|---------------------|
| MYS DRAWN | CC, SW DESIGNED |
| JK, MH CHECKED | - APPROVED |
| 10/07/22 DATE | 20-05-23 PROJECT |



PURPOSE: STORMWATER BMP & HABITAT RESTORATION

IN: MEETINGHOUSE CREEK
COUNTY: SUFFOLK STATE: NY

DATE: 10/07/22

SHEET 14 of 17

NOTES:

- MOUND CONFIGURATION WILL VARY DEPENDING ON EXISTING VEGETATION AND ACCESS CONSIDERATIONS. MAINTAIN EXISTING MATURE WOODY VEGETATION.
- TOPOGRAPHIC MOUNDS ARE INTENDED TO MIMICK NATURAL WETLAND MICROTOPOGRAPHY. MOUNDS SHALL BE SHAPED TO MIMIC WETLAND HUMMOCKS CREATED BY NATIVE SHRUBS, HERBACEOUS PLANTS, AND NURSE LOGS.
- TYPICAL MOUND DIMENSIONS ARE APPROXIMATELY 3 FT TO 8 FT ACROSS.
- PEAKS OF MOUNDS SHALL BE 5 FT TO 10 FT APART.

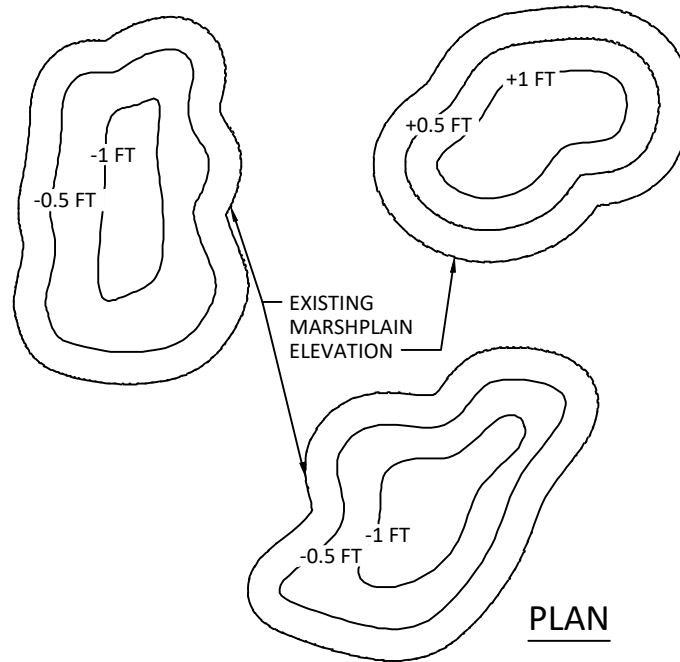

SECTION

NYSDEC
APPROVED AS PER TERMS
AND CONDITIONS OF

PERMIT NO *1-4730-01079/00002*

DATE: *9/7/2023*

1 TYPICAL DETAIL - MICROTOPOGRAPHY
15 NOT TO SCALE

NEIWPC, PEP, & TOWN OF RIVERHEAD
MEETINGHOUSE CREEK STORMWATER WETLAND
& HABITAT RESTORATION
AQUEBOGUE, NY

MICROTOPOGRAPHY

| | |
|-------------------|---------------------|
| MYS DRAWN | CC, SW DESIGNED |
| JK, MH CHECKED | - APPROVED |
| 10/07/22 DATE | 20-05-23 PROJECT |



PURPOSE: STORMWATER BMP & HABITAT RESTORATION
IN: MEETINGHOUSE CREEK COUNTY: SUFFOLK STATE: NY
DATE: 10/07/22
SHEET 15 of 17

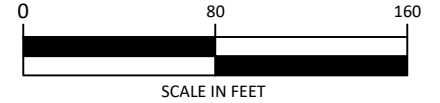

PLANTING AREAS:

- LOW MARSH AREA = 14,378 SF 0.33 AC
- HIGH MARSH AREA = 23,053 SF 0.53 AC
- FORESTED WETLAND = 14,569 SF 0.33 AC
- UPLAND PLANTING = 6,118 SF 0.14 AC

FOREBAY AND MIRCPOOL AREA = 5,354 SF 0.12 AC
 TOTAL PROPOSED WETLAND AREA = 57,354 SF 1.32 AC
 TOTAL UPLAND RESTORATION AREA = 6,118 SF 0.14 AC

LEGEND

- - - - - EXISTING 1 FT CONTOUR
- PROPOSED 1 FT CONTOUR
- PARCEL LINE
- ~~~~~ TREE LINE
- - - - - SD - - - - - SD STORM DRAIN
- - - - - GAS LINE
- - - - - OVERHEAD UTILITIES
- - - - - LIMIT OF DISTURBANCE
- ▲▲▲▲▲ UPLAND
- + + + + + FORESTED WETLAND
- /// /// HIGH MARSH
- ~~~~~ LOW MARSH
- NORMAL INUNDATION
- FIELD DELINEATED WETLAND



NYSDEC
 APPROVED AS PER TERMS
 AND CONDITIONS OF

PERMIT NO *1-4730-01079/00002*

DATE: *9/7/2023*

LEGEND (CONT.)

- ACCESS ROAD
- ▨ ROCK - TYPE A
- ▩ ROCK TYPE B AND TYPE C
- FABRIC ENCAPSULATED SOIL LIFTS

NEIWPCC, PEP, & TOWN OF RIVERHEAD
 MEETINGHOUSE CREEK STORMWATER WETLAND
 & HABITAT RESTORATION
 AQUEBOGUE, NY

NATIVE PLANTING PLAN

| | |
|-------------------|---------------------|
| MYS DRAWN | CC, SW DESIGNED |
| JK, MH CHECKED | - APPROVED |
| 10/07/22 DATE | 20-05-23 PROJECT |



PURPOSE: STORMWATER BMP &
 HABITAT RESTORATION
 IN: MEETINGHOUSE CREEK
 COUNTY: SUFFOLK STATE: NY
 DATE: 10/07/22
 SHEET 16 of 17

| PLANTING TABLE | | | | | | |
|---------------------------------------|--|----------------------|-----------------|---------------|------------|----------|
| PLANTING ZONE | DESCRIPTION | | | | | |
| | SCIENTIFIC NAME | COMMON NAME | STOCK TYPE | MINIMUM SIZE | SPACING | QUANTITY |
| LOW MARSH (UP TO 1 FT INUNDATION) | TYPHA LATIFOLIA | BROAD-LEAVED CATTAIL | 2-IN PLUG | | 18-IN O.C. | 1,280 |
| | SCHOENOPLECTUS TABERNAEMONTANI | SOFT-STEMMED BULRUSH | 2-IN PLUG | | 18-IN O.C. | 1,280 |
| | SCIRPUS CYPERINUS | WOOLGRASS | 2-IN PLUG | | 18-IN O.C. | 1,280 |
| | CAREX STRICTA | TUSsock SEDGE | 2-IN PLUG | | 18-IN O.C. | 1,280 |
| | ACORUS CALAMUS | SWEET FLAG | 2-IN PLUG | | 18-IN O.C. | 1,280 |
| HIGH MARSH (UP TO 3 IN INUNDATION) | CAREX LURIDA | LURID SEDGE | 2-IN PLUG | | 18-IN O.C. | 1,240 |
| | CAREX VULPINODEA | FOX SEDGE | 2-IN PLUG | | 18-IN O.C. | 1,240 |
| | CAREX SCOPARIA | BLUNT BROOM SEDGE | 2-IN PLUG | | 18-IN O.C. | 1,240 |
| | JUNCUS EFFUSUS | SOFT RUSH | 2-IN PLUG | | 18-IN O.C. | 1,240 |
| | PANICUM VIRGATUM | SWITCH GRASS | 2-IN PLUG | | 18-IN O.C. | 1,240 |
| | EUPATORIUM MACULATUM | JOE PYE WEED | 2-IN PLUG | | 18-IN O.C. | 1,240 |
| | EUPATORIUM PERFOLIATUM | BONESET | 2-IN PLUG | | 18-IN O.C. | 1,240 |
| | ASCLEPIAS INCARNATA | SWAMP MILKWEED | 2-IN PLUG | | 18-IN O.C. | 1,240 |
| | VERNONIA NOVEBORACENSIS | NEW YORK IRONWEED | 2-IN PLUG | | 18-IN O.C. | 1,240 |
| FORESTED WETLAND | ACER RUBRUM | RED MAPLE | 3-GAL CONTAINER | 2-4 FT HEIGHT | 12-FT O.C. | 20 |
| | NYSSA SYLVATICA | BLACK GUM | 3-GAL CONTAINER | 2-4 FT HEIGHT | 12-FT O.C. | 20 |
| | QUERCUS PALUSTRIS | PIN OAK | 3-GAL CONTAINER | 2-4 FT HEIGHT | 12-FT O.C. | 20 |
| | CLETHRA ALNIFOLIA | SWEET PEPPERBUSH | 3-GAL CONTAINER | | 12-FT O.C. | 20 |
| | CORNUS AMOMUM | SILKY DOGWOOD | 3-GAL CONTAINER | | 12-FT O.C. | 20 |
| UPLAND | JUNIPERUS VIRGINIANA | EASTERN RED-CEDAR | 3-GAL CONTAINER | 2-4 FT HEIGHT | 12-FT O.C. | 10 |
| | PINUS RIGIDA | PITCH PINE | 3-GAL CONTAINER | 2-4 FT HEIGHT | 12-FT O.C. | 10 |
| | PINUS STROBUS | WHITE PINE | 3-GAL CONTAINER | 2-4 FT HEIGHT | 12-FT O.C. | 10 |
| | ILEX GLABRA | INKBERRY HOLLY | 3-GAL CONTAINER | 2-4 FT HEIGHT | 12-FT O.C. | 10 |
| | ILEX OPACA | AMERICAN HOLLY | 3-GAL CONTAINER | 2-4 FT HEIGHT | 12-FT O.C. | 10 |
| | VIBURNUM DENTATUM | ARROWWOOD | 3-GAL CONTAINER | 2-4 FT HEIGHT | 12-FT O.C. | 10 |
| SEEDING SCHEDULE | LOW MARSH (0.33 AC): PINELANDS NURSERY WETLANDS GRASS AND SEDGE MIX (OR APPROVED EQUIVALENT) AT 18 LBS PLS PER ACRE & CEREAL RYE (SECALE CEREALE) AT 15 LBS PLS PER ACRE AS NURSE CROP | | | | | |
| | HIGH MARSH (0.53 AC): PINELANDS NURSERY WETLANDS GRASS AND SEDGE MIX (OR APPROVED EQUIVALENT) AT 18 LBS PER ACRE & CEREAL RYE (SECALE CEREALE) AT 15 LBS PLS PER ACRE AS NURSE CROP | | | | | |
| | FORESTED WETLAND (0.33 AC): PINELANDS NURSERY RIPARIAN BUFFER MIX (OR APPROVED EQUIVALENT) AT 18 LBS PLS PER ACRE & CEREAL RYE (SECALE CEREALE) AT 15 LBS PLS PER ACRE AS NURSE CROP | | | | | |
| | UPLAND (0.14 AC): PINELANDS NURSERY NORTHEAST COASTAL GRASSLAND MIX (OR APPROVED EQUIVALENT) AT 15 LBS PLS PER ACRE & CEREAL RYE (SECALE CEREALE) AT 15 LBS PLS PER ACRE AS NURSE CROP | | | | | |

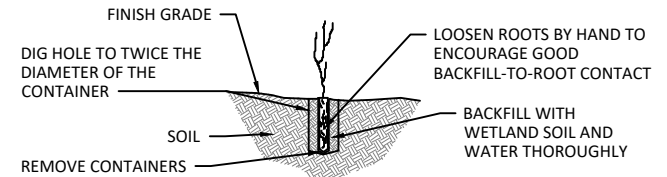

1
17
TYPICAL DETAIL - PLUG
NOT TO SCALE

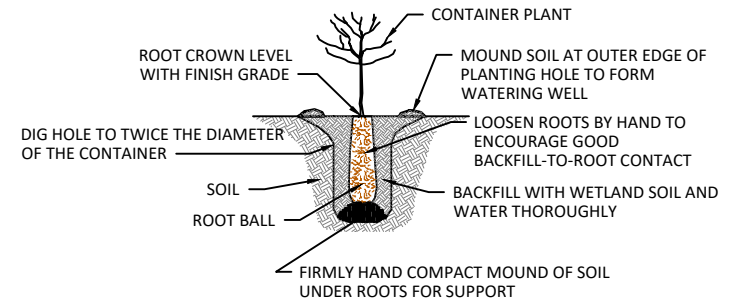

2
17
TYPICAL DETAIL - CONTAINER PLANT INSTALLATION
NOT TO SCALE

NYSDEC
APPROVED AS PER TERMS
AND CONDITIONS OF

PERMIT NO 1-4730-01079/00002
DATE: 9/7/2023

NEIWPC, PEP, & TOWN OF RIVERHEAD
MEETINGHOUSE CREEK STORMWATER WETLAND
& HABITAT RESTORATION
AQUEBOGUE, NY

NATIVE PLANTING NOTES

| | |
|-------------------|---------------------|
| MYS DRAWN | CC, SW DESIGNED |
| JK, MH CHECKED | - APPROVED |
| 10/07/22 DATE | 20-05-23 PROJECT |

220 Concord Ave, 2nd Floor
Cambridge, MA 02138
617.714.5537
www.interfluve.com

PURPOSE: STORMWATER BMP & HABITAT RESTORATION
IN: MEETINGHOUSE CREEK
COUNTY: SUFFOLK STATE: NY
DATE: 10/07/22
SHEET 17 of 17